

Hot Water Units .....	181
Tanks, Containers, Accessories .....	183
Hoses & Filters .....	189
Plumbing Fittings .....	194
Pumps .....	200
Bathroom Modules .....	206
Sinks & Basins .....	207
Tapware .....	209
Filtration .....	215
Gas Compliance & Safety .....	216
Gas Copper Pipe & Fasteners .....	217
Gas Fittings & Adaptors .....	217
Gas Cylinders & Products .....	221
Gas Hoses .....	222
Gas Regulators .....	223

## HOT WATER UNITS

### CAMEC DIGITAL INSTANTANEOUS GAS HOT WATER SYSTEM

**051459 13KW GAS WATER HEATER WHITE DOOR**

**051460 13KW GAS WATER HEATER BLACK DOOR**

Instantaneous Water Heater system is an economical solution for RV's to supply constant hot water. Unlike 240V systems that draw extensive current, clever design of this system means it can operate for many hours at maximum heating capacity from just one 9kg gas bottle! The digital controller gives you flexibility to set your desired water temperature plus peace of mind knowing the water temperature can be controlled so it will not be too hot for children. One of the key benefits of an RV instantaneous water heater is that gas is only used when water flows (the water heater is activated by the initial flow of water through the system). In other storage tank systems, energy is required on a continual basis to keep the water stored at the desired temperature and with an instantaneous system, you are able to use all of the available water in your RV's storage tank(s).

#### FEATURES

- Designed specifically for RV use
- Australian Gas and Watermark Approvals
- Operates from 12V DC & Gas
- Continuous hot water flow
- Remote digital temperature controller with error code display and on/off switch
- Up to 60% less gas consumption than regular tank models
- No anode to replace
- Door lock compatible with Camec One Key System
- Door lock compatible with Camec One Key System
- Easy to install and suits most existing water heater cut outs
- Patented rain protection exhaust
- Low power and gas usage



#### SPECIFICATIONS

- Super-efficient 46,500BTU heating power
- Weight 12.1kg
- Installation cut-out dimensions: 330mm(w) x 330mm(h) x 380mm(d)
- Water temperature selectable from 35-60°C
- Minimum starting water flow: 1.5L/min
- Shut down water flow: 1.0 l/min
- Temperature rise at 5.0L/min water flow: 37.7°C
- Power requirement: 10.5-15V DC
- Maximum current 1.5A
- Nominal Gas Consumption (MJ/h): 49.1
- Efficiency: >90%

## CAMEC WATER HEATER SPARE PARTS

CODE	PRODUCT NAME
043994	HWS WHITE SPARE DOOR ONLY
043995	HWS BLACK SPARE DOOR ONLY
044746	CAMEC IWH HEAT EXCHANGER
044747	CAMEC IWH BURNER
044748	CAMEC IWH SILICON TUBE 300MM
044749	CAMEC IWH WATER FLOW SENSOR
044750	CAMEC IWH WATER INLET
044751	CAMEC IWH WATER DRAIN VALVE
044752	CAMEC IWH PRESS RELIEF VALVE
044753	CAMEC IWH THERMOSTAT
044754	CAMEC IWH AIR PRESSURE SWITCH
044755	CAMEC IWH GAS VALVE
044756	CAMEC IWH IGNITOR 12V B121(IS)
044757	CAMEC IWH DIGITAL CONTROLLER
044758	CAMEC IWH ELECTRONIC CTRL UNIT
044759	CAMEC IWH MAIN WIRE HARNESS
044760	CAMEC IWH 12V POWER LEAD
044761	CAMEC IWH DISPLAY CABLE SHORT
044762	CAMEC IWH DISPLAY CABLE 5M
044763	CAMEC IWH COLD WATER SENSOR
044764	CAMEC IWH HOT WATER SENSOR
044765	CAMEC IWH EXHAUST PIPE
044894	CAMEC IWH VENTILATOR



## MAGNESIUM ANODE ROD

**035975 SOLD LOOSE****044044 RETAIL PACKAGING**

Slightly acidic water is fine to drink and wash with, but it can degenerate your water heater over time. Some water heaters have an in-built anode rod of soft metal that will break down instead of the other components of the water heater. Anodes should be replaced when they have degraded more than 75%, usually yearly, but this is dependent on the quality of water used.

## FEATURES

- Magnesium AZ31
- To suit Suburban hot water systems

## SPECIFICATIONS FOR 044044

- Size: 17mm x 235mm
- Thread: 3/4" NPT

## SPECIFICATIONS FOR 035975

- 21.30mm x 300mm
- Thread: 3/4" BSP

SUBURBAN 240V ELEMENT  
1440W**040710**

Suburban 240V Element 1440W, 6amp, will suit SW6DEA, SW5EA & SW4DEA.

## SPECIFICATIONS

- 240V Element
- 1440W, 6amp
- Thread 1 inch NPT (32.4mm outside diameter)

## SOCKET 1 1/16INCH

**043383**

To replace suburban anodes

# TANKS, CONTAINERS, ACCESSORIES



## TANK CLEEN 200G

000261

Cleans and deodorises freshwater tanks.

### FEATURES

- An effective remedy for water tainting problems
- Treats up to 182 litres

### SPECIFICATIONS

- 200gm



## 2.5M LEAD T/S WATER MONITOR

006133

Extension lead for 040282, 040283, 040284, Water Tank Sender Probes



## WATER TANK GAUGE

006118 1 TANK

006119 2 TANKS

006120 3 TANKS

Simple monitoring of fresh or grey water. One kit per tank required.

### FEATURES

- For under chassis low profile tanks, please use either code 040282, 2.5m probe, code 040283, 5m probe, or code 040284, 7.5m probe
- For deep tanks please use code 006116, tank sender probe kit



## LED WATER TANK GAUGE/VOLTMETER

043453 SINGLE WATER TANK GAUGE LCD

043454 1 WATER LVL & 1 BATTERY GAUGE

043455 DOUBLE WATER TANK GAUGE LCD

043456 2 WATER LVL & 1 BATTERY GAUGE

043457 TRIPLE WATER TANK GAUGE LCD

These gauges have a coloured LCD analogue display with LED backlighting for crystal clear viewing. Only 50mA draw so they can be left on without flattening your on-board battery. There is a power on/off switch to turn the gauge off when the caravan is not in use.

### FEATURES

- Monitors water tank, either metal or plastic
- Five levels are indicated on display
- Constant display of levels without needing to press a button
- On/Off switch when caravan is not being used

### SPECIFICATIONS

- Dimensions: 108mm x 108mm
- From 10 to 20mm thick
- 12V connection and tank plug entry at rear requires a cutout 50mm wide x 20mm high
- Colour of needle changes to red and flashes at the lowest (RES) level
- Sender probes for water tanks not included See 040282/040283/040284/006116



## WATER AND WASTE GAUGE

006121

Simple monitoring of fresh and grey water  
Incorporates its own battery power supply and no connection to vehicle's power supply is required.  
One probe kit per tank required.

### FEATURES

- For water sender probes - under chassis low profile tank, please use code 040282, 2.5m probe, or code 040283, 5m probe or 040284, 7.5m probe
- For deep tanks please use code 006116, tank sender probe kit
- 2 gauges - 1 water / 1 waste



## WATER TANK SENDER PROBE

040282 2.5M

040283 5.0M

040284 7.5M

### SPECIFICATIONS

- Water tank sender probe for use with RV Traveler
- LED Tank Gauge for "under chassis low profile tanks"
- 3 different length cables available to suit Sp installation requirements.



## WATER TANK SENDER PROBE KIT

006116

To suit deeper tanks - 5 probes are mounted into the side of the tank (fresh or grey water only). Supplied with wiring kit, one junction box and 5m lead.

### FEATURES

For under chassis low profile tanks, please use either code 040282, 2.5m probe, code 040283, 5m probe, or code 040284, 7.5m probe



## JRV WATER

006139 JRV FRESH WATER TANK MONITOR

006144 JRV WATER MONITOR FRESH/GREY/BL

006147 JRV WATER TANK MONITOR BLACK

### FEATURES

- These systems allow the tank level monitoring of fresh water, grey water, black water.
- Includes sender probes



## SINGLE WATER TANK GAUGE

**051213**

You now have the ability to customise the kit to suit your requirements with a range of single tank, double tank and triple tank gauges to be matched with 2.5 metre, 5 metre or 7.5 metre lead sender probes. With one push of the test button you are able to monitor the water levels of up to three tanks.

There is no need to wire in a 12 volt supply as the top indicator gauge comes complete with its own battery, which is easily replaced when the need arises.

The water gauge measures only H65mm x W65mm x D11mm so it is small enough to fit any application.

### SPECIFICATIONS

- 1 Sender Probe Required



## DOUBLE WATER TANK GAUGE

**051214**

You now have the ability to customise the kit to suit your requirements with a range of single tank, double tank and triple tank gauges to be matched with 2.5 metre, 5 metre or 7.5 metre lead sender probes. With one push of the test button you are able to monitor the water levels of up to three tanks.

There is no need to wire in a 12 volt supply as the top indicator gauge comes complete with its own battery, which is easily replaced when the need arises.

The water gauge measures only H65mm x W65mm x D11mm so it is small enough to fit any application.

### SPECIFICATIONS

- 2 Sender Probes Required not included  
See 040282/040283/040284/006116



## TRIPLE WATER TANK GAUGE

**051215**

You now have the ability to customise the kit to suit your requirements with a range of single tank, double tank and triple tank gauges to be matched with 2.5 metre, 5 metre or 7.5 metre lead sender probes. With one push of the test button you are able to monitor the water levels of up to three tanks.

There is no need to wire in a 12 volt supply as the top indicator gauge comes complete with its own battery, which is easily replaced when the need arises.

The water gauge measures only H65mm x W65mm x D11mm so it is small enough to fit any application.

### SPECIFICATIONS

- 3 Sender Probes Required



### MODULAR 43 LITRE WATER TANK

043394 WATER TANK 43L MODULAR  
 043708 MODULAR TANK A INC FITTINGS  
 043709 MODULAR TANK B INC FITTINGS  
 043410 CAP 20MM 3/4 FBSP  
 043411 GE20 ELBOW 20MM 3/4 FBSP  
 043412 REDUCING SOCKET 25 TO 20MM  
 043414 ADAPTOR 20 FBSP TO 15 MBSP  
 043426 TEE FITTING 3/4 F BSP

The modular caravan and RV tank is blow moulded from food contact approved, high molecular weight, high density polyethylene. This makes the tank a super tough performer. Moulded with two integral 20mm (3/4 MBSP) threads that can accept a wide variety of standard fixtures and fittings. Using these standard fittings, the tanks can be networked together to provide almost limitless water storage options for your vehicle.

#### SPECIFICATIONS

- 2 x 3/4 (20mm) MBSP
- Dimensions: 260mm(w) x 220mm(d) x 860mm(l)
- When installation configuration has been chosen, drill a 3-4mm hole in the top of each tank to allow for air venting



### UNIVERSAL WATER /WASTE TANK

044267

Blow moulded universal caravan and RV water tank which can be configured in many ways to provide a single low cost solution to your water or grey water storage requirements. Blow moulded from food contact approved high molecular weight high density polyethylene. This makes the tank a super tough performer. The tank is moulded with two integral 40mm (1 1/2" BSP) threaded female closures that can accept a wide variety of standard fixtures and fittings. Using these standard fittings the tank can be networked together to provide many water storage options for your vehicle. When installation configuration has been chosen, drill a 3-4mm hole in the top of each tank to allow for air venting.

#### SPECIFICATIONS

- Weight: 2.5kg
- 1 1/2" BSP
- Dimensions: 698mm(l) x 210mm(d) x 382mm(w)



### ALKO 11.5 GL WATER TANK 52 LT

006089

Plastic, tough, non toxic fresh water tank for caravans and recreational vehicles.

#### FEATURES

- Has two small drilled breather holes (no thread) on the upper corner of the tank
- The top also has two tapered red plastic push in bungs that cover holes left from the manufacturing process

#### SPECIFICATIONS

- Dimensions: 1010mm(l) x 175mm(h) x 330mm(w)
- Capacity: 52 litres (11.5 gallons)



### ROTO CAMPER 55 LITRE WATER TANK (NO BARBS)

006096

Plastic fresh water tank for caravans and recreational vehicles.

#### FEATURES

- Australian made from food contact approved resin

#### SPECIFICATIONS

- Dimensions: 760mm(l) x 350mm(h) x 230mm(d)
- Capacity: 55 litre (12 gallons)
- Can be installed vertically or horizontally on the long side
- No barbs
- 3/4" BSP FEM inlet
- 2 x 3/8" BSP FEM (vent and outlet)



### WATER TANK

033422 136L-59LT 1/2BSP OUTLETS

033423 186L-82LT 1/2BSP OUTLETS

Plastic fresh water tank, tough, non-toxic. Used by Australian caravan manufacturers.

#### FEATURES

- High density polyethylene
- Foodgrade

#### SPECIFICATIONS

- Tank comes with two 1/2" BSP plugs
- Outlets are 2 x 1/2" female BSP
- Inlet 25mm barb
- 006083 Screw in breather to suit (not included)
- 59LT = 840 x 480 x 180mm
- 82LT = 1190 x 480 x 180mm
- For breather use 006083



### ROTO 61 LITRE ROUND CORNER WATER TANK

006097

Plastic, tough, non toxic, fresh water round corner tank for caravans and recreational vehicles.

#### FEATURES

- Australian made from food contact approved resin

#### SPECIFICATIONS

- Dimensions: 900mm(l) x 490mm(w) x 175mm(d)
- Capacity: 61 litre (13 gallons)
- Outlet: 1/2" barb
- Inlet: 1" barb
- Drilled breather hole



### **ROTO 70 LITRE WATER TANK (NO BARBS)**

**006099**

Plastic fresh water tank for caravans and recreational vehicles.

#### **FEATURES**

- Australian made from food contact approved polyethylene

#### **SPECIFICATIONS**

- Dimensions: 860mm(l) x 525mm(w) x 165mm(d)
- Capacity: 70 litre (15 gallons)
- No barbs
- Inlet 3/4" F thread
- Outlet 3/8" F thread
- Small drilled breather hole



### **ROTO 84 LITRE WATER TANK**

**006100**

Tough, non toxic standard fresh water tank for caravans and recreational vehicles.

#### **FEATURES**

- Australian made from food contact approved resin
- 860L x 525W x 220H



### **WATERTANK 95 LITRE**

**050593**

This 95L Universal Water Tank can be setup as either a Fresh Water or Grey Water Tank using the associated fitting kit

#### **FEATURES**

- Offset flush point allowing for 100% flushing of tank
- Fitting Kits available for Fresh or Grey Water Setups

#### **SPECIFICATIONS**

- Capacity: 95 Litres
- Dimensions(mm): 1170 x 500 x 220



### **WATERTANK 110 LITRE**

**050595**

This water tank has a 110L capacity and can be setup as either a Fresh Water or Grey Water tank using the associated fitting kit

#### **FEATURES**

- Specialty Mounting Brackets Available
- Can be used as a Fresh or Grey Water Tank

#### **SPECIFICATIONS**

- Capacity: 110L
- Dimensions(mm): 1200 x 650 x 180



### **WATER TANK MOUNTING BRACKETS**

**035609 FOR 61 LITRE, 006097/033422 TANKS**

**035610 FOR 70 LITRE, 006099 TANK**

**035611 FOR 84 LITRE, 006100 TANK**

**035612 FOR 100 LITRE**

**035613 FOR 127 LITRE**

**044379 FOR 50 LITRE, 044267 TANK**

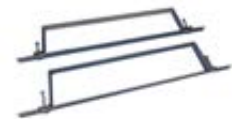

### **WATERTANK BRACKETS**

**050608**

Mounting Brackets to suit Camec's 110L Universal water tank 050595.



### **FIAMMA WATER TANK 70L -R**

**051320**

The Fiamma 70Lt fresh water tank is made of non-toxic material and can be installed either vertically or horizontally. Comes with 38mm inlet and all necessary fittings for installation.



**WATERTANK FITTINGS 95F****050605**

This kit includes all the required fittings to setup Camec's 95L universal water tank as a Fresh Water Tank.

**FEATURES**

- 25mm Barb Inlet
- 40mm Cap
- 20mm Plug
- 13mm Outlet
- 13mm Breather

**WATERTANK FITTINGS 95G****050604**

This kit includes all the required fittings to setup Camec's 95L Universal water tank as a Grey Water Tank.

**SPECIFICATIONS**

- 40mm Ball Valve
- 13mm Breather
- 40mm Inlet Adaptor
- 2 x 20mm Plug

**WATERTANK FITTINGS F110****050607**

This kit includes all the required fittings to setup Camec's 110L Universal water tank as a Fresh Water Tank.

**SPECIFICATIONS**

- 25mm Barb Inlet fittings
- 40mm Cap
- 13mm Breather
- 12mm Outlet (JG fittings)

**WATERTANK FITTINGS G110****050606**

This kit includes all the required fittings to setup Camec's 110L universal water tank as a Grey Water Tank.

**SPECIFICATIONS**

- 40mm Ball Valve
- 1/2" BSP CAP
- 13mm Breather
- 40mm Inlet Adaptor

**CAMEC WATER TANK BARB OUTLET DRILLED****006079**

To suit Camec water tanks 006096/006099

**SPECIFICATIONS**

1/2" barb x 3/8" BSP

**CAMEC WATER TANK BARB PLUG UNDRILLED****006080**

To suit Camec water tanks.

**SPECIFICATIONS**

- 1/2" barb x 3/8" BSP

**DRAIN CAP FOR CAMEC MK2 WATER TANK****006087****SPECIFICATIONS**

- 1/2" female BSP thread

**TEE FOR CAMEC MK2 55LT WATER TANK****006088****SPECIFICATIONS**

- 1/2" BSP male to 2 x 25mm hose barb fittings

**1/2" PLUG BSP****042652**

To suit Camec Water Tanks.



### **WATER TANK PLUG**

**051265**



### **CAMEC WATER TANK DRAIN TAP**

**043772**

To suit Camec water tanks, twin thread

#### **SPECIFICATIONS**

- 3/8" BSPM x 1/2" male barb
- 1/2" BSPM if required



### **BARREL UNION**

**044375**

1 1/2" FMBSP UNION



### **BARREL UNION NIPPLES**

**044374**

1 1/2" MBSP NIPPLE



### **1/2IN BSPT PLUG**

**033427**



### **PLASTIC BUSH 1/2BSPM X 3/8BSPF**

**033881**

To suit Camec 033422, 033423 water tanks. To reduce outlets to 3/8" BSP female.



### **BREATHER 10MM BARB X 3/4 MALE BSP**

**006083**

Suits 033422 and 033423 water tanks



# HOSES & FILLERS

## SPEEDFIT TWIST AND LOCK RANGE PLUMBING FITTINGS

The Twist and Lock range of WaterMarked plumbing fittings were designed for use in normal domestic plumbing applications in accordance with 'AS/NZS 3500', 'AS 4176 (ISO 15875/21003)'. The 12mm range is popular with the caravan and motor home market.

An additional benefit the Twist and Lock range offers is that a twist of the screw cap locks the pipe into place and gives increased compression on the O-Ring for even greater security.



### 12MM COLLET CLIP - WATERMARKED

044127 BLUE

044128 RED

Use on watermarked fittings for easy identification of hot or cold water



### 12MM ELBOW CONNECTOR - WATERMARKED

044129

12MM pipe



### 12MM END STOP - WATERMARKED

044122

12MM pipe



### 12MM EQUAL TEE CONNECTOR - WATERMARKED

044117

12MM pipe



### 12MM INSERT SUITE BPEX - WATERMARKED

044125

12MM pipe. Recommended for all connections to ensure pipe stays round. Especially after cutting.



### 12MM STEM ELBOW - WATERMARKED

044118

12MM pipe



### 12MM STEM TEE - WATERMARKED

044121

12MM pipe



### STRAIGHT CONNECTOR - WATERMARKED

044130

12MM pipe



### 12MM X 1/2" BSP ELBOW TAP CONNECTOR - WATERMARKED

044120

12MM X 1/2" BSP female



### STRAIGHT TAP CONNECTOR - WATERMARKED

044119

12MM X 1/2" BSP female



### BRASS STRAIGHT ADAPTOR - WATERMARKED

044123

12MM X 1/2" BSP male



### FEMALE ADAPTOR - WATERMARKED

044124

12MM X 3/8" female BSP



### ELBOW CONNECTOR 15MM PIPE - WATERMARKED

050609

#### SPECIFICATIONS

- Fitting Direction 90°
- Fitting Type Elbow
- Suits 15mm pipe



### BRASS UNIVERSAL HOSE ADAPTOR

042691



### BRASS EZ HOSE CONNECTOR

042692



### FLOOR SEAL T/S HOSE 10-19MM OD

040868

#### SPECIFICATIONS

- White
- To suit hose 10-19mm outer diameter
- Pack of 100



### FLUTED WASTE/SULLAGE HOSE

005280 BLACK CORRUGATED HOSE 25MM ID

044459 HOSE FLUTED WASTE 25MM X 10M ROLL

005284 HOSE FLUTED WASTE 25MM X 20M

043365 SULLAGE HOSE 28MM X 10M ROLL

044072 HOSE FLUTED WASTE 32MM X 20M

This hose uses nitrile to minimise the permeation of odours through the hose when used with sanitation systems in boats, caravans and recreational vehicles.

#### FEATURES

- Excellent UV resistance to withstand extreme Australian conditions
- Ribbed outer cover provides superior resistance to abrasion
- Recommended for water applications where a long lasting hose is required
- Black



### CAMEC DRINKING WATER HOSE

005303 12MM X 10M

005301 12MM X 20M

005304 12MM X 100M (SOLD PER METRE)

Non toxic, no taste. Hose will not taint the water.

#### SPECIFICATIONS

- Plastic fittings attached for easy connection to a garden tap on 10m and 20m rolls
- Weight: 10m - 1.3kg
- Weight: 20m - 2.11kg



### BLACK VINYL FOOD GRADE HOSE

005267 12.5MM X 30M X 2MM WALL

005269 25MM X 30M X 3.5 WALL

Ideal for RV plumbing and many other applications.

#### FEATURES

- Complies with Australian standards
- Use where plumbing may be exposed to light to reduce algae growth

#### SPECIFICATIONS

- Internal diameters of 12.5 and 25mm
- Will withstand temperatures from -10°C up to 60°C
- Smooth bore and outer surface



### HOSE BAG

044486 SMALL

044485 LARGE

Small bag holds 10m of fresh or 5m of sullage hose. Large bag holds 20m of fresh or 10m of sullage hose.



### CLEAR VINYL FOOD GRADE HOSE

035559 CVT 10MM 30M

005272 VINYL CVT 12MM 30M

005274 VINYL CVT 25MM 30M

Ideal for RV plumbing and many other applications. Clear hose is best used in areas not exposed to light.



### MULTI-REEL LARGE & COMPACT

043265 LARGE REEL

005313 COMPACT REEL

#### SPECIFICATIONS - LARGE

- Ready for your power lead or other uses.
- 37 cm diameter
- 44 cm including handle
- 8 cm deep
- 0.9 kg when empty
- Approx. 30m power cord capacity

#### SPECIFICATIONS - COMPACT

- 34cm diameter including handle
- 6.5cm deep
- 0.6kg when empty. Holds approx 15m power cord



### CAP ONLY TO SUIT FIAMMA WATER FILTER

043326 WHITE WITH KEY

043327 BLACK WITH KEY

Replacement locking water cap



### RECESS WATER FILLER & CAP

006176

To suit Camec water tanks.

#### SPECIFICATIONS

- White
- Commonly used on retro/vintage caravans
- Suits 25mm filler hose



### HOSE FLAT DRINKING WATER

005309 HOSE FLAT DRINKING WATER 10M

005310 HOSE FLAT DRINKING WATER 15M

Ideal for connection to caravans and motor homes using snap-on high quality brass fittings.

#### FEATURES

- High flow
- Food grade liner
- Solid brass fittings
- Tangle free storage
- Complete with reel

#### SPECIFICATIONS

- Internal diameter of 19mm, which provides a high flow
- Weight: 10m - 2.05kg
- Weight: 15m - 3.0kg



### FIAMMA LOCKABLE WATER FILLER

006169 BLACK

006170 WHITE

Locking water cap.

#### SPECIFICATIONS

- Requires 80-82mm hose
- 10mm barb for breather
- 40mm barb for filler hose



### WATER FILLER

006173 COMPLETE FILLER

006174 FLAP ONLY

Plastic water filled with hinged flap. Suits 25mm filler hose



### CAMEC LOCKABLE WATER FILLER

039945 WHITE RIGHT HAND HINGE

039946 BLACK RIGHT HAND HINGE

040269 WHITE LEFT HAND HINGE

040270 BLACK LEFT HAND HINGE

Lockable water filler supplied with 2 keys.

#### FEATURES

- One piece filler neck
- Lockable water filler supplied with two keys
- Camec One Key Fits All barrel housing
- Available in both left and right hand hinged flap
- Flap opens 180° to be flush with the RV wall
- Emergency opening feature from the inside

#### SPECIFICATIONS

- 10mm barb for breather hose
- 25mm barb for filler hose
- Requires 85mm hole



### HOSE FLAT SULLAGE

038685 6M 25MM ID

005315 9M 25MM ID

005316 9M 32MM ID

For general use on caravans and motor homes.

#### FEATURES

- For grey water disposal
- Smooth surface for easy cleaning
- No seeping
- Save on space
- Complete with multi reel

#### SPECIFICATIONS

- Weight: 6m - 1.9kg
- Weight: 9m - 2.6kg
- Weight: 9m x 32mm - 3.2kg



### REPLACEMENT CAP & KEY LOCKABLE WATER FILLER

006160 WHITE

006161 BLACK



## IN LINE PRESSURE REDUCER

051095

350KPa  
15MM FxF

Fitted in line to prevent over pressure conditions  
Pressure limited to 50psi out



## SHURFLO CITY WATER ENTRY

006150 CITY WATER PRESS CONTROL CAP ONLY

006154 WHITE

006155 WHITE RETAIL PACK

006156 CHROME

006158 CHROME RETAIL PACK

043432 BLACK

043433 BLACK RETAIL PACK

Combined mains pressure water entry, pressure regulator and check valve. Reduces mains pressure to 50psi.

### FEATURES

- Leak tight, stress and crack resistant
- Quick, easy wall mount

### SPECIFICATIONS

- Water pressure is limited to 50psi



## BRASS ADAPTOR CLICK ON 11/16" USA THREAD

005399

### FEATURES

- Click-on 1 1/16" American thread
- Used on Shurflo City Water entry



## CITY WATER ENTRY FITTING

005398 PLASTIC

Snap on hose fitting to suit the SHURflo In-line Water Entry.

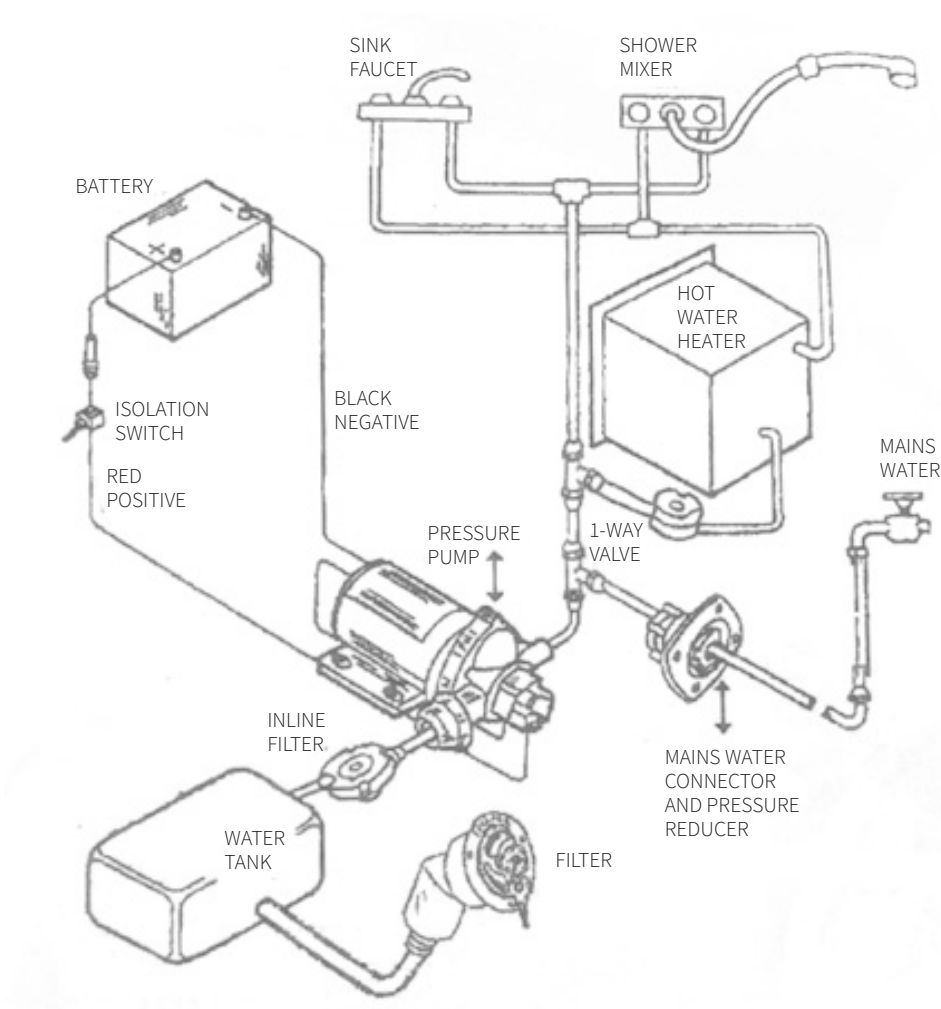

## ACETAL METRIC FITTINGS

The PM range of fittings are manufactured from an acetal copolymer with food grade nitrile O-rings. Being especially produced for food stuffs and potable liquids

## HOW SUPER SPEEDFIT WORKS

To make a connection, the tube is simply pushed in by hand; the unique patented John Guest collet locking system then holds the tube firmly in place without deforming it or restricting flow.

## MATERIALS OF CONSTRUCTION

Super Speedfit fittings are made up of three components:

Bodies - are produced in an acetal copolymer or polypropylene.

'O' rings - are Nitrile rubber or EPDM

Collets - are produced in acetal copolymer or polypropylene with stainless steel

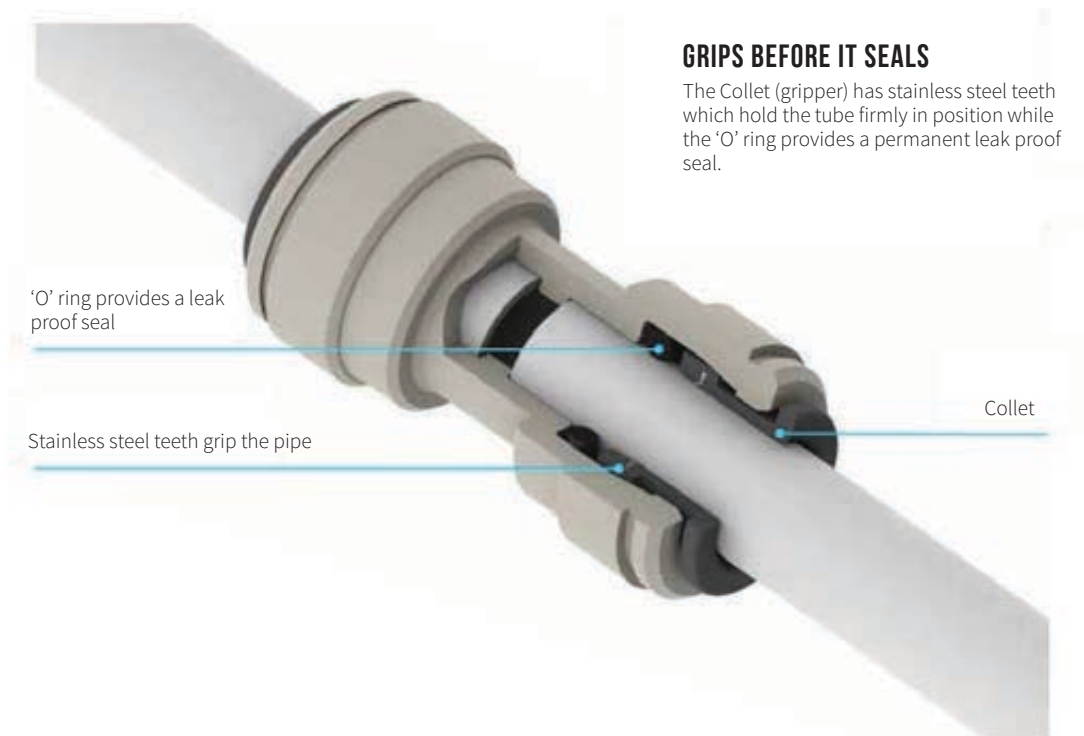

### GRIPS BEFORE IT SEALS

The Collet (gripper) has stainless steel teeth which hold the tube firmly in position while the 'O' ring provides a permanent leak proof seal.

'O' ring provides a leak proof seal

Stainless steel teeth grip the pipe

Collet

## HOW TO MAKE A CONNECTION



### CUT THE TUBE SQUARE

Cut the tube square and remove burrs and sharp edges. Ensure the outside diameter is free of score marks. For soft or thin walled tube we recommend the use of a tube insert.



### PUSH THE TUBE STRIP

Push the tube into the fitting, to the tube stop.

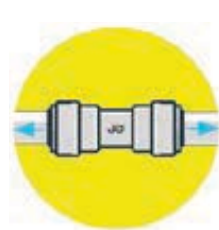

### PULL TO CHECK SECURE.

Pull on the tube to check it is secure. Test the system before use.



### TO DISCONNECT

Push in collet and remove tube. To disconnect, ensure the system is depressurized, push the collet square against the fitting. With the collet held in position the tube can be removed.



# PLUMBING FITTINGS



**REDUCING SOCKET 20 TO 15MM**  
043413



**ELBOW BSP TO 12MM**  
005441 12MM X 1/2IN M/BSP (JG)  
005434 12MM X 3/8IN M/BSP (JG)  
042585 12MM X 1/2" M/BSP



**ELBOW MALE/FEMALE 12MM X 12MM STEM**  
005440 (JG)  
Elbow: 12mm pipe to 12mm stem



**BPEX PIPE 50M - WATERMARKED**  
044126  
**SPECIFICATIONS**  
• 12MM  
• 50M roll



**ELBOW FEMALE CONNECTOR 12X12MM**  
005430 (JG)  
Suits 12mm pipe



**REDUCING CONNECTOR 12-10MM**  
005447  
Plastic reducing adaptor from 12mm to 10mm pipe.



**STRAIGHT CONNECTOR 12X12MM**  
005431 (JG)  
Suits 12mm pipe



**ADAPTOR STEM**  
005439  
1/2" M/BSP x 12MM  
Plastic stem adaptor to suit 12mm connectors



**ADAPTOR FEMALE BSP**  
005433 12MM X 3/8" F/BSP (JG)  
005436 12MM X 1/2" F/BSP (JG) |  
051772 6MM X 1/4" BSP



**ADAPTOR**  
005437 12MM X 3/8" M/BSP (JG)  
005435 12MM X 1/2" M/BSP (JG)  
042581 12MM X 1/2" M/BSP (JG) & O RING (JG)



**BRASS ADAPTOR 12MM MALE BSP**  
005442  
Used on hot water systems



**BULKHEAD (JG) ADAPTOR 12MM**  
042059  
"Thru wall" connection for 12mm John Guest pipe



**UNION CONNECTOR**  
051774 6MM  
051779 15MM



**LOCKING CLIP 12MM - RED****005444 SUITS JG FITTINGS**

Optional locking clip to fit 12mm push-on fittings.

**FEATURES**

- Prevents leaks or release when pipe is forced to a side
- Can be removed if the fitting is to be removed
- Essential if pipe does not meet fitting at correct angle

**DM CLIP LOCKING 12MM - RED****005467 SUITS DM FITTINGS****EQUAL DIVIDER 12MM****038944**

Splits a single inlet pipe into two separate lines.

**TUBE SUPPORT INSERT - 12MM****005443**

Inserted into JG pipe to ensure shape stays round and sits flush against the face of push-fit fittings. Recommended for all JG connections but especially on the hot water line.

**STRAIGHT ADAPTOR****050992**

12MM X 3/8 BSP

**COLLET COVER 12MM - BLACK****005445**

Prevents accidental removal or tampering with piping. Removable as required.

**REDUCER 15MM X 12MM****005438**

Reduces 15mm pipe to 12mm. 15mm male stem.

**TEE CONNECTOR****005429 12MM****051776 6MM**

Equal tee connector for JG 12mm pipe.

**FLOW BEND CLIP****050991**

Suits 12mm pipe

**CONNECTOR 15MM X 1/2IN BARB****005432**

15mm pipe to 1/2" ID PVC hose

**SWIVEL ELBOW BRASS END****038790**

1/2" male brass end with elbow to take 12mm pipe. Used on taps and water heaters

**WATER 1/2IN BARB - HOSE****038657**

Conversion from 12mm JG pipe to 12mm ID flexible hose. Chrome

**JOHN GUEST TUBE 12MM LLDPE****005252 BLACK - 100MM****005254 RED - 100MM****005256 BLUE - 100MM**

Linear Low Density Polyethylene for cold and intermittent hot water applications, water purification, water conditioners, ice makers and misting systems.

**FEATURES**

- Wide range of temperature and pressure suitability, broad chemical compatibility and made from non-contaminating materials
- Excellent resistance to environmental stress cracking as measured by ASTM D-1693 (10% IGEPAL)

**SPECIFICATIONS**

- Available per meter and as a 100 metre roll
- FDA compliant materials



### BACK PLATE ELBOW

**042781**

Used to either add a tap to your A-Frame or accept mains pressure water into your caravan. This accepts a 15mm John Guest pipe on one side and allows a tap or inlet with 1/2 BSP thread to screw into threaded side.

#### FEATURES

- Suits 15mm pipes.
- Can be altered to suit 12mm pipe by using a 12mm Push-On to 15mm Push-In Smooth Adapter (sold separately).

#### SPECIFICATIONS

- Backing plate
- 15mm push-in fitting
- 1/2 Inch Female BSP thread



### PLASTIC TUBE CUTTER

**042584**

Plastic tube cutter for 12MM plastic tubing.



### JG PLASTIC PIPE CUTTER

**051672**

JG Pipe Cutter suitable for the cutting of JG Speedfit barrier pipe up to a 22mm Diameter. Cuts Speedfit Barrier Pipe, Nylon Pipe, Plastic Hose, Rubber Hose. The unique V-point blade pierces hard or soft plastic tubing. The blade then slices through to give a clean, easy cut with virtually no tube deformation. One squeeze does the job. Ergonomically designed handles.



### SHUT OFF VALVE IN-LINE STRAIGHT

**042583**

12mm pipe fittings



### BARREL UNION NIPPLES

**050821**

1" male thread both sides



### CAMLOCK WITH 25MM BARB TYPE C

**034817 FEMALE**

**034818 MALE**

Female Camlock with 25mm barb used to connect two hoses with 25mm inner diameter when used in conjunction with equivalent female camlock.

#### FEATURES

- Supplied with R clips x 2 to lock in camlock
- Often used to join 25mm waste hose
- Polypropylene



### RED PLUG 12MM

**042782**

Pushes into a 12mm JG push-fit fitting to terminate the line.



### IN-LINE CHECK VALVE 12MM

**042582**

Push-on fitting to allow flow in one direction only.

#### FEATURES

- Prevents water returning down a pipe



### PIPE RETAINING CLIP 12MM WIDE

**042638 15MM**

**042639 27MM**

**042640 35MM**

Single mount hole saddle with insulation to stop vibration.



### HOSE CLAMP WORMDRIVE ALL ZINC FINISH

**005330 10-16MM**

**005331 12-22MM**

**005332 20-32MM**

**005333 25-40MM**

These general purpose hose clamps are ideal for hose sealing and use in many different applications with a high mechanical load.

#### FEATURES

- Improved asymmetric housing
- Screw support: Ease of assembly due to the safe guidance of the emerging band end
- Material and clamping range stamped on the band
- Asymmetric extension - prevents the housing from tilting over when the clamp is tightened

#### SPECIFICATIONS

- Screw and housing: Mild steel zinc plated and clear chromate



### ELBOW CONNECTOR PUSH ON 15MM

**050993**



### CONNECTOR PLASTIC HOSE FEMALE 12MM SNAP-IN

**005415**

**HOSE CONNECTOR****042601 12MM X 1/2" HOSE - STANDARD****042602 STOP 12MM X 1/2" HOSE - STOPS THE FLOW OF WATER WHEN DISCONNECTED****TAP ADAPTOR BSP UNIVERSAL****042603**

1" or 3/4" (with adaptor) female thread to click-on hose fitting

**HOSE COUPLER 12MM 2 WAY****042604**

Joiner used to connect two clip-on hose fittings.

**DIRECTOR****005354 10MM BARB X 1/2 M/BSP****005355 13MM BARB X 1/4 M/BSP****042641 13MM BARB X 1/2 M/BSP****042651 13MM BARB X 3/4 M/BSP****042647 25MM BARB X 3/4 M/BSP****042650 25MM BARB X 1 M/BSP****NUT AND TAIL 32MM****051467**

32mm barb to 1 1/4" female thread

**NUT AND HOSE TAIL****044013**

40MM Barb x 1 1/2" FBSP

Washer Included

**DIRECTOR 32MM****051466**

32mm barb x 1 1/4" male thread

**MALE HOSE TAIL****044373**

40mm BARB X 1 1/2" MBSP

**ELBOW THREAD PLASTIC****005368 25M BARB X 3/4" MBSP****042654 13MM BARB X 1/2" MBSP****ELBOW BARBED PLASTIC****042695 13MM****042644 25MM****FEMALE ADAPTER****051135**

3/4" BSP female thread to 12mm JG hose

**IN LINE FILTER PLASTIC 13MM****042648 13MM SHORT - 135MM OVERALL LENGTH****042696 13MM LONG - 230MM OVERALL LENGTH**

Perfect for tight spaces.

**END STOP 12MM****050407 BLACK****FEMALE ADAPTOR****051317 12MM X 3/8 FBSP SHALLOW THREAD**



### JOINER

005371 BARBED JOINER X 10MM TAILS  
042693 BARBED JOINER 13MM  
042645 BARBED JOINER 25MM



### JOINER 13MM HOSE X 3/4IN M/NPT

005411  
Fitted to the end of a hose to then suit the Shurflo  
City Water entry



### JOINER 13MM HOSE X 3/4IN F/NPT

005412  
Female fitting to suit 005411



### NUT & TAIL

042658 3/4" BSP X 13MM BARB  
042659 1" BSP X 13MM BARB  
042646 1" BSP X 25MM BARB



### PVC BALL VALVE

050820  
1" female BSP threads



### REDUCER

005378 REDUCER PLASTIC BARB 13MM TO 10MM  
005382 REDUCER PLASTIC BARB 32MM TO 25MM  
042657 BARBED JOINER REDUCING 25MM TO 19MM  
051770 REDUCER 12MM TO 8MM  
051771 REDUCER 8MM TO 6MM



### REDUCING BUSH

050922  
1 1/2" male thread to 3/4" female



### REDUCING BUSH 40MM - 32MM

051468  
1 1/2" male thread to 1 1/4" female thread



### REDUCING NIPPLE

050923 40 X 20MM  
11/2" female thread to 3/4" female thread



### TEE

005383 BARBED TEE 10MM  
042694 BARBED TEE 13MM  
042649 BARBED TEE 25MM  
051780 15MM



### FEMALE CONNECTOR

051293 12MM X 3/8 BSP



### MALE CONNECTOR

051773 6MM X 1/4" BSP  
051778 15MM X 1/2" BSP

**THREADED TEE FBSP 13MMX1/2****042653**

13mm hose barb with 1/2" BSP male fitting

**ONE-WAY VALVE (2313)****005798**

One way valve to suit 10mm hose

**SHURFLO INLINE CHECK VALVE 1/2 BARB****005789**

Shurflo Non Return Valve. Safeguards against back surge up to 100PSI, suitable for most pump systems. 12mm clamp on hose.

**BARBED SHUT OFF VALVE****042643 13MM****042655 25MM****NON RETURN VALVE 25MM PVC****035606****FEATURES**

- Stepped ends to suit either 25mm or 38mm ID hose

**TAP INLINE PLASTIC 13 X 13MM****005401**

1/2" low density poly quick action valve - barbed at both ends.

**WATER HEAT TEMPER VALVE****039244**

This device is placed after the hot water system and mixes cold water when required to prevent water exceeding the temperature set.

**FEATURES**

- Tamper-proof adjustment, adjuster key prevents accidental adjustment
- Dezincification resistant
- Meets Australian Standard for potable water supply
- Individually tested and calibrated

**SPECIFICATIONS**

- Maximum of 50 degrees C.
- All threads are 1/2 inch male BSP

**ADJ WATER PRESS REDUCING VALVE PRV15****039245**

Protects downstream installations from variations in supply pressure. Adjustable 155-550kPA.

**TEMPERING VALVE 12MM****042586**

Designed to accurately regulate the temperature of water for activities such as showering, bathing and hand washing and reduces the risk of scalding. Ideal for caravan and RV plumbing.

**FEATURES**

- Lightweight and easy to install
- Preset to 50°C
- AS/NZ 4020 (water contract approval)

**UNION ELBOW****051775 6MM****TUBE SUPPORT****051781 15MM****TUBE****051777 6MM NATURAL****050409 8MM WHITE**





## FLOJET 12V TRIPLEX PUMP C-TICK

### 041723 QUAD FITTINGS

The Flojet Triplex 12V Pump has 11 litres per minute water flow, 50 psi, automatic cut-off switch and is C-Tick approved. The pump is supplied with two Flojet quad port fittings that have been developed for the Australian RV market using John Guest and DM 12mm plumbing. The 12mm OD tube connects directly into each quad port fitting, eliminating the need to purchase adaptors. This not only saves cost but allows for quicker installation.

#### FEATURES

- C-Tick approved
- Supplied with 2 x quad port fittings to suit 12mm OD tube
- Automatic cut off switch
- Note: Filter sold separately to pump - refer code 041775

#### SPECIFICATIONS

- Dimensions: 200mm(l) x 130mm(h) x 120mm(w)
- Flow Rate: 11L/min
- Pressure: 50 psi
- Amps: 8 max
- Fittings: 2 x Quad to suit 12mm push-in pipe



## FLOJET PUMP AND FILTER

### 005702 12V

### 043251 24V

Super quiet, reliable demand pumps. Complete with filter.

#### FEATURES

- Smooth operation without accumulator tank
- Permanent magnet, ball bearing motor
- Four chamber diaphragm design
- Corrosion resistant materials
- Includes bypass

#### SPECIFICATIONS

- Dimensions: 99mm(h) x 160mm(W) x 206mm(L)
- Flow Rate: 12.5L/min
- Pressure Switch: 15psi (1.1 bar) cut in - 35psi (2.5 bar) cut out
- Amp Draw: 3.9A
- Fittings: 1/2" barb, 1/2" thread. Snap in fittings



## FLOJET 12V COMPACT PUMP 3/8" BARBS

### 005700

Compact, automatic shut off, 12V pump.

#### FEATURES:

- Self priming
- Dry running
- Soft, noise absorbing mounts
- Smooth operation without accumulator tank

#### SPECIFICATIONS

- Dimensions: 157mm(l) x 58mm(h) x 89mm(w)
- Weight: 1.6kg
- Flow Rate: 3.8L/min
- Pressure: 35 psi
- Voltage: 12V
- Amps: 4A
- Fittings: 3/8" barb, adaptor to 1/2" barb included



## FLOJET FILTER 1/2" BARB FILTER QUAD PORT FITTED TO PUMP

### 005706

#### SPECIFICATIONS

- Filter (strainer) inlet, 12mm barb to Quad with elbow
- Plug in quad port 90° strainer allows for easy installation and compatibility



## FLOJET 1/2 THREADED STRAIGHT

### 005711

1/2" BSP thread to quad



## FLOJET 12V RV PUMP

### 005727

Self priming 12V diaphragm pump with 1/2" fittings.

#### FEATURES

- Self primes up to 2.4m vertical lift
- Four piston design delivers higher flow rates
- Quick connect plug-in ports for easy installation
- Pressure switch control to run the pump only as needed
- Includes an internal bypass to eliminate pulsating flow and switch chatter

#### SPECIFICATIONS

- Dimensions: 208mm(l) x 95mm(h) x 160mm(w)
- Weight: 2.03kg
- Flow Rate: 12.1L/min up to 17L/min
- Pressure Switch: 22psi cut in - 35psi cut out
- Voltage: 12V
- Amps: 7 max
- Fittings: 2 x straight Quad to 1/2" MBSP, 1 x straight Quad to 1/2" barb, 1 x elbow Quad to 1/2" barb



## FLOJET 1/2 FITTING STRAIGHT PAIR OF QUAD FITTINGS

### 039903



## FLOJET 1/2 BARB ELBOW

### 005704

Quick connect quad port fitting incorporating a 90° elbow with 1/2" barb.



**FLOJET INLINE FILTER****041775**

The Flojet 40 mesh filter has a quick connect quad port fitting to suit Flojet pumps and the filter mesh is easily removed for cleaning.

**FLOJET SIDE CLIPS****005710**

Replacement quad fitting clips for use on the flojet pumps. Sold per pair.

**FLOJET 1/2 BARB STRAIGHT UNION****005705**

Quad fitting to 1/2" barb

**FLOJET 3/4 BARB STRAIGHT****005709**

Quad fitting to 3/4" barb

**FLOJET 1/2 THREADED ELBOW****005707**

Quad fitting to 1/2" male bsp threaded elbow

**FLOJET 1/2 BARB IN-LINE FILTER****005712**

Removable cover for easy cleaning. 1/2" barbs

**FLOJET IN-LINE FILTER 1/2" MALE  
THREAD BOTH ENDS****005724**

Removable cover for easy cleaning. 1/2" male thread fittings.

**FLOJET REPAIR KIT****005714****SPECIFICATIONS**

- Check valve assembly
- Diaphragm assembly
- Side clips
- Drive cam assembly

**FLOJET PRESS SWITCH ASSEMBLY - 35PSI****005716****FLOJET DIAPHRAGM KIT****005715**



## FIAMMA ACCUMULATOR TANK A20

**035603**

May be used with most pump systems and may be mounted in any position.

### SPECIFICATIONS

- Dimensions: 240mm(l) x 100mm(h) x 100mm(d)
- Universal expansion tank that eliminates pulsating pump operation and supplies a constant flow in the required quantity



## SHURFLO AQUA KING PUMP

**043430 12V**

SHURflo Aqua King pump automatically senses when the tap has been switched on. Ideal for RV or marine applications. Reliable and quiet, it can run dry without damage.

### FEATURES

- Multi-fixture applications
- Self-priming and sealed switch
- Seamless shell e-coated motor
- Ignition and thermally protected

### SPECIFICATIONS

- Dimensions: 180mm(l) x 110mm(h) x 130mm(d)
- Flow Rate: 11.35L/min
- Pressure: 55psi
- Voltage: 12V
- Amps: 5 max
- Fittings: 1/2" MBSP



## SHURFLO 12V 4009 STANDARD PUMP

**040860 12V STANDARD UNBOXED**

**043243 12V STANDARD RETAIL BOXED**

SHURflo's 4009 Series fresh water pump was created with a unique one piece diaphragm and internal bypass, assuring long life and top performance in all plumbing systems. The 4009 series pump is constructed for high flow demand, low noise and no rapid cycling. SHURflo's quality reputation has been built on the reliability and dependability of every pump they build. The 4009 series fresh water, automatic demand pump is quiet, thermally protected and can run dry without damage.

### FEATURES

- Internal bypass will prevent rapid cycling
- C-Tick approved
- 4 chamber diaphragm pump

### SPECIFICATIONS

- 12VDC permanent magnet
- Intermittent duty
- Shut Off: 45psi
- Dry Prime: 1.82m
- 11.3 LPM



## SHURFLO 12V COMPACT PUMP

**005698 UNBOXED**

**043241 RETAIL BOXED**

This compact automatic demand fresh water pump offers durability and dependability making it ideal for low volume, intermittent duty applications. The 105 pump self-primers up to 2.0 vertical metres while delivering over 3.8Lpm. A 12V low power consumption motor, equipped with thermal protection and long life pressure switch rated to 30PSI, provides high pump performance and reliability.

### FEATURES:

- Self primes up to 2.0m vertically while delivering up to 3.8L/min
- Perfect for low volume, intermittent duty applications
- Compact automatic demand pump
- Inlet and outlet: 10mm (3/8") barb



## SHURFLO 12V COMPACT PUMP & TAP KIT

**005699**

Faucet offers smooth, easy flow with a washer-less ceramic disc design. Versatile 360 degree spout rotation.

### SPECIFICATIONS

- Pump and switched faucet combined in the one kit



## SHURFLO 4048 12V STANDARD PUMP ONLY

**041554**

Pump guarantees quiet operation and smooth performance while providing the ultimate in durability and reliability.

### FEATURES

- Thermally protected
- Smooth flow

### SPECIFICATIONS

- 15L/min
- Voltage: 12V
- Pressure: 55psi



### SHURFLO 24V 4009 STANDARD PUMP ONLY

041556

These potable water pumps are self-priming and employ four independent pumping chambers to pump water smoothly and quietly.

#### SPECIFICATIONS

- Inlet and outlet: 1/2" male BSP threaded
- 30psi shut off
- 24 volt
- multi-fixture
- 1.82m (6 feet) prime



### SHURFLO 12V BLASTER PUMP N/S

034384 RETAIL BOX

Perfect for tough wash down applications such as fish box, scaling and anchor chain cleaning.

#### FEATURES

- Supplied with spray nozzle
- Delivers high lift, can run dry without damage and will not overheat with extended use
- Rugged and self-priming

#### SPECIFICATIONS

- Flow Rate: 13.2L/min
- Pressure: 45psi



### SHURFLO 12V NAUTLUS PUMP 1GPM

005588

Tough, rugged and compact. Designed to deliver 3.7L/min with minimal power consumption. Perfect for low volume, single fixture applications. Protected from thermal overload.

#### FEATURES

- Tough, rugged and compact
- Requires in-line switch and 3A fuse
- 3/8" barbs
- 2.1A max
- Not self priming



### SHURFLO 12V AQUAKING JUNIOR 2GPM

005656

This 2 GPM pump guarantees quiet operation and smooth performance while providing the ultimate in durability and reliability. This 12V DC pump is designed and built for the harsh marine environment and for 1-2 fixture applications.

#### FEATURES

- Self-priming and sealed switch
- Seamless shell e-coated motor
- Ignition and thermally protected

#### SPECIFICATIONS

- Dimension: 184mm(l) x 127mm(h) x 118mm(w)
- Flow Rate: 7.6L/min (2.0gpm)
- Voltage: 12V DC
- Amps: 4A
- Shut-Off Pressure: 30psi



### SHURFLO 24V BLASTER WASH PUMP

005604 24V PUMP

Rugged and self-priming. Perfect for tough washdown applications such as fish box, scaling and anchor chain cleaning. Supplied with spray nozzle.

#### FEATURES

- Ignition protected
- Switches are sealed against water damage
- Delivers high lift, can run dry without damage
- Won't overheat with extended use

#### SPECIFICATIONS

- Dimension: 203mm(w) x 136mm(l) x 127mm(h)
- Flow Rate: 13.2 L/min
- Voltage: 24V DC -3A
- Pressure: 45psi



### SHURFLO BILGE PUMP 500

036770

This pump is built for the harsh marine environment to withstand the toughest conditions.

#### FEATURES

- Submersible with 3" tinned wire assembly
- Anti-airlock
- Ignition protected

#### SPECIFICATIONS

- ABS housing with nylon impeller



### SHURFLO SWIVEL UNION

005407 1/2BX1/2F

005408 1/2BX1/2F

005410 3/4BX1/2F

Note: these will not give a water tight seal on all BSP threads as they also rely on the internal section making contact with the internal flared SHURflo/Flojet pump thread

### SHURFLO PRESSURE ACCUMULATOR N/S

034387

Pre-pressurised to 20psi, cycling pulsation is reduced and pressure spikes up to 125psi increasing the life of the pump and saving battery power.

#### SPECIFICATIONS

- 1/2" NPTM
- Pressure: 30psi

### SHURFLO SWIVEL ELBOW

005404 1/2" FEMALE TO 1/2" BARB

005406 1/2" FEMALE TO 3/4" BARB

Nut and tail to suit 12mm hose. Tighten by hand only.

- Please note, these will not give a water tight seal on all BSP threads as they also rely on the internal section making contact with the internal flared SHURflo/Flojet pump thread



### SHURFLO CLASSIC TWIST ON FILTER

**005672 1/2" INLET AND OUTLET M-F**

**034391 1/2" INLET AND 1/2" BARB OUTLET**

Fits directly to the inlet of all Classic and Aqua King pumps.

#### FEATURES

- The transparent design allows for easy visual check while the bowl allows easy cleaning

#### SPECIFICATIONS:

- 1/2" NPSM Inlet
- Stainless steel mesh



### WHALE ONE-WAY IN-LINE VALVE

**005785**

When fitted in line on the suction side of a pump, Whale non-return valves will ensure maintenance of prime, particularly if pump valves are weak.

#### SPECIFICATIONS

- Suit 12.5mm ID hose
- Ideal for holding water primed on hand pumps (p.29)



### WHALE SUPERSUB 12V PUMP GP1352

**035605 SUBMERSIBLE**

Suitable for dual purpose manual/electric systems.

#### FEATURES:

- Does not require priming
- Simple, compact and low cost
- Self venting design eliminates air locking
- Designed to be dropped into a water tank
- Inexpensive way to update from a manual to an electric system

#### SPECIFICATIONS

- Dimensions: 116mm(l) x 50mm(h) x 50mm(d)
- Weight: 150g
- Output: Up to 12L/M at zero discharge head
- Pumps fresh, saltwater and diesel
- Low power consumption
- Suits 10mm or 12mm (with supplied adaptor)

CODE	PRODUCT NAME
043924	SHURFLO PRESSURE SWITCH
042112	SHURFLO 12V 4009 SWITCH 45 PSI
005674	SHURFLO 2088 DIAPH DRIVE KIT
070035	SHURFLO UPPER HOUSING T/S
042114	SHURFLO 12V 4009 UPPER ASSY 45
042116	SHURFLO 12V 4009 DRIVE ASSY
042117	SHURFLO 12V 4009 CHECK VALVE
005677	SHURFLO 2088 UPPER HOUSING &SW
005641	SHURFLO 2088 MICRO SWITCH
005666	SHURFLO PUMP REPAIR KIT





### WHALE 12V PUMP IN LINE

**005753**

In-line, 12V centrifugal pump, light enough to be suspended in the hose line. Sealed against casual water.

#### FEATURES

- Simple, compact and low cost
- Boosts pressure in manual or electric pump systems
- Ideal for up to two mixer outlets
- Lightweight, fits unsupported into pipework
- Fits neatly below water tank

#### SPECIFICATIONS

- Dimensions: 135mm(l) x 38mm(h) x 38mm(d)
- Weight: 150g
- Output: 10L/min
- Hose tails accept 3/8" or 1/2" ID hose
- Low current draw



### WHALE 12V PORTABLE PUMP KIT

**043259**

Handy 12V submersible pump with accessories.

#### FEATURES:

- Simply drop the pump into your water supply and then plug it in
- Great for filling your caravan fresh water tank from a jerry can when camping
- Great for washing down bikes, surf boards etc
- Robust pump suitable for cold and warm water, diesel, light oils and water-based fluids including most water based pesticides
- Pumps up to 15 litres per minute
- Maximum continuous usage should not exceed 15 minutes

#### KIT INCLUDES

- Whale supersub pump
- 3.75m clear hose and nozzle
- 3.75m lead for 12V connections to a cigarette lighter
- Battery terminal adaptor



### WHALE SUPERSUB 921 12V PUMP

**005751**

Suitable for dual purpose manual/electric systems.

#### FEATURES

- Self venting design eliminates air locking
- Designed to be dropped into a water tank
- Does not require priming
- Simple, compact and low cost
- Inexpensive way to update from a manual to an electric system

#### SPECIFICATIONS:

- Dimensions: 160mm(l) x 50mm(h) x 50mm(d)
- Weight: 200g
- Flow Rate: 15L/min
- Pumps fresh, saltwater and diesel
- Low power consumption



### WHALE PRESSURE SWITCH

**005754**

When fitted inline provides a convenient way to create a pressure system with an electric pump without its own switch.

#### SPECIFICATIONS

- Current Rating: 10A 12/24V
- Cut Out Pressure: Within range 5-25psi



### WHALE TIP TOE SERVICE KIT

**005581**

Service kit for Whale Tip-Toe foot pump

# BATHROOM MODULES



## SOAP DISPENSER

**042872 SINGLE 400ML**  
**042873 DOUBLE 400ML X 2**

400ml dispenser available as an individual unit or double. Backing plate is fixed to the wall with screws (provided) or silicone, etc. and dispensers are removable. For hand soap, dish washing liquid, shampoo and body wash. Use in the caravan bathroom or kitchen. If the button is held in, soap will continue to flow until it is released. Colour is white with clear panels so that you can see when to re-fill.



## CHROME 6 PIECE SET

**002109**

### FEATURES

- Set of 6. Includes: soap dish holder, toilet roll holder, towel rail, towel ring, glass tumbler and holder.
- Chrome



## SUPER SUCTION

**039885 TOILET ROLL HOLD**  
**039888 HOOK 3KG**  
**039889 TOWEL RING**  
**039890 SOAP DISH**  
**039891 BASKET 3 IN 1**

Instantly transform a room with an affordable premium suction product. Ideal for homes, motor homes, caravans and offices.

### FEATURES

- Super suction
- One step installation
- Removable
- Press button action
- Chrome painted ABS plastic

### SPECIFICATIONS

- Weight Load: 3kg



## CLEO CABINET WITH SLIDING MIRROR

**040836 CABINET**  
**044104 CLEO MIRRORS AND BUTTON**

Featuring twin mirror sliding doors complete with a travel lock to ensure the cabinet remains secure whilst on the road. The Cleo vanity cabinet comes with retaining bars as well as a handy accessories shelf.



## CLEO BASIN TIP UP

**040835**

An ideal vanity sink unit for caravan, boat and motor home bathrooms with limited free space. The Cleo tip up sink/folding vanity basin features an integrated soap and toothbrush holder and a simple lift up basin.

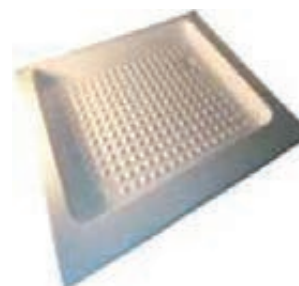

## SHOWER TRAY VT90 830X670X55MM

**002166**

High gloss, ABS, shower tray.

### SPECIFICATIONS

- Dimensions: 830mm(l) x 670mm(h) x 55mm(d)
- Made to suit the Thetford Cassette toilet C402 Series.



# SINKS & BASINS



## BASIN RECTANGULAR 330 X 285MM

043616

Note: The top surface that normally sits above the bench top on these basins is not as smooth as the inner surface of sink/basin - it is not a fault but a function of the manufacturing process.

### SPECIFICATIONS

- White
- Use with pop-up waste 043373
- Plug not included
- Dimensions: 330mm(l) x 120mm(h) x 285mm(d)
- Inside Sink Dimensions: 300mm(l) x 120mm(h) x 250mm(d)
- Waste Hole: 40mm (diam)



## BASIN ACRYLIC CORNER 279 X 279MM

043617

Acrylic corner basin/sink.

### SPECIFICATIONS

- Dimensions: 279mm(l) x 120mm(h) x 279mm(d)
- Inside Sink Dimensions: 280mm(l) x 210mm(w)
- Plug not included
- Waste Hole: 40mm (diam)
- Use with pop-up waste 043373
- White



## BASIN RECTANGULAR 508 X 178MM

043618

Acrylic, light and sturdy rectangular basin/sink.

### FEATURES

- Sits into a cutout in a bench top or can be attached to wall
- Includes soap drainer
- Space for single tap on either side

### SPECIFICATIONS

- Dimensions: 508mm(w) x 130mm(h) x 178mm(d)
- Plug not included
- Waste Hole: 40mm (diam)
- Use with pop-up waste 043373
- White



## CAMEC STAINLESS STEEL SINK WITH DRAINER

006046

Top quality stainless steel basin and drainer.

### FEATURES

- Foam tape and 8 brackets included
- Does not include plug or waste

### SPECIFICATIONS

- Dimensions: 780mm(w) x 170mm(h) x 480mm(d)
- 34mm waste outlet



## BASIN SS

038170 315MM X 265MM X 145MM INTERNAL BOWL

038171 327MM X 278MM X 150MM INTERNAL BOWL

038172 352MM X 282MM FULL FLANGE X 155MM

Top quality stainless steel basins available in a number of sizes.

### FEATURES

- Lip sits flush on bench top
- Waste hole size 34mm
- Use waste 006072 / 006073 & 006064 plug



## CAMEC STAINLESS STEEL SINK WITH DRAINER

038169

Top quality stainless steel basin and drainer.

### FEATURES

- Foam tape and 10 brackets included
- Does not include plug or waste

### SPECIFICATIONS

- Dimensions: 760mm(w) x 155mm(h) x 360mm(d)
- 34mm waste outlet



## SINK STAINLESS STEEL SINK 780MM X 480MM

042976

Includes waste, plug and mounting clips.

### SPECIFICATIONS

- Dimensions: 780mm(w) x 480mm(d) x 170mm(h)
- Dimensions of main sink: 330mm(w) x 380mm(d)
- 90mm waste outlet



## CAMEC STAINLESS STEEL ROUND BASIN 450MM

042974

Includes waste, plug and mounting clips.

### SPECIFICATIONS

- Dimensions: 450mm(diam.) x 180mm(d)
- 90mm waste outlet



## CAMEC STAINLESS STEEL SINK 890MM X 480MM

042973

Includes waste, plug and mounting clips.

### SPECIFICATIONS

- Dimensions: 890mm(w) x 480mm(d) x 170mm(h)
- Dimensions of main sink: 315mm(w) x 380mm(d)
- Dimensions of secondary sink: 155mm(w) x 300mm(d)
- 90mm waste outlets



## CAMEC STAINLESS STEEL ROUND BASIN & DRAINER

042975

Includes waste, plug and mounting clips.

### SPECIFICATIONS

- Dimensions: 850mm(w) x 450mm (d) x 170mm
- Dimensions of sink: 357mm (diam.)
- 90mm waste outlet



## BASKET STYLE PLUG FOR SINKS

043358

Replacement basket (strainer) for 90mm sink waste outlets



## MINI CORNER BASIN WITH FULL SKIRT

044832 BASIN

### FEATURES:

- Useful in shower/toilet combination rooms for space-saving corner design. Neatly hides plumbing behind the skirt
- Does not include mounting screws or a waste outlet
- 45mm waste outlet



## WASHBASIN

050945 WHITE

050946 BLACK

### SPECIFICATIONS

- White
- Bench top wash basin
- Ceramic
- Weight 5kg
- 48mm waste hole
- No waste included



## POP UP WASTE KIT

043373

Suit 40mm waste hole. Pop up sink plug



## WASTE KIT FOR 45MM SINK HOLE

042871



## PLASTIC WASTE OUTLET 25MM STANDARD

006072

Straight waste suitable for 25mm hose.

### FEATURES

- Plug sold separately
- Straight waste
- Suit 34mm hole



## PLASTIC 90° WASTE OUTLET 25MM

006073

Suit 34mm hole



## RUBBER SINK PLUG

006064 25MM RED

035578 32MM RED

04184 32MM BLACK - SUIT042871 WASTE KIT

# TAPWARE



## CAMEC HAND PUMP CHROME

**043156**

Robust chrome plated brass hand pump for drinking water.

### FEATURES

- Self priming, dual action
- Easy installation

### SPECIFICATIONS

- Height Above Bench: 65mm
- Suits 1/2" tubing
- Chrome plated



## BREHA HAND PUMP

**005542 BLACK**

**005543 WHITE**

**005554 TOP PLUNGER SEAL**

**005555 BOTT PLUNGER SEAL BLACK**

**035599 WASHER KIT BS100 & BS101**

Self priming and simple to install.

### SPECIFICATIONS

- Fits a sink with a 32mm mounting hole



## BREHA HAND PUMP SHORT WHITE

**005546**

Self priming and simple to install.

### SPECIFICATIONS

- Fits a sink with a 32mm mounting hole
- White
- Shorter barrel for more clearance under the bench top



## HAND PUMP FYNspray

**005549**

Black moulded nylon body with chrome plated brass handle and swiveling spout. Suitable for fresh or salt water.

### SPECIFICATIONS:

- Output: 1L/per 5 strokes



## CAMEC BASIN MIXER 110MM FIXED SPOUT

**041716 CAMEC BASIN MIXER 110MM FIXED**

**042792 40MM REPLACEMENT CARTRIDGE**

Basin mixer with 110mm fixed spout with a 40mm cartridge.

### FEATURES

- WELS rated complies Australian/NZ standard AS/NZS 6400
- Stainless steel braided hoses 350mm length and 1/2" female BSP threads
- 40mm cartridge



## CAMEC BASIN MIXER 150MM SPOUT

**041674**

Basin mixer with 150mm spout with a 40mm cartridge.

### FEATURES

- WELS rated complies Australian/NZ standard AS/NZS 6400
- Stainless steel braided hoses 350mm length and 1/2" female BSP threads
- 40mm cartridge
- Able to be swiveled



## CAMEC SINK MIXER 220MM SPOUT

**041675**

Sink mixer with 220mm spout with a 40mm cartridge.

### FEATURES

- WELS rated complies Australian/NZ standard AS/NZS 6400
- Stainless steel braided hoses 350mm length and 1/2" female BSP threads
- 40mm cartridge
- Able to be swiveled



## VALTERRA CHROME ROCKER HAND PUMP

**044831**

COLD WATER RV FAUCET: Hand pump is ideal for RV's and campers with a holding tank that require a pump faucet

EASY TO USE: Rotate the handle back and forth to pump water through the faucet

FUNCTIONAL PRIME LOCK: Keep the water in prime hold position for immediate water release, or leave the line in drain position to return water to the holding tank

EASY TO INSTALL: Simply drill a hole through the countertop, place pump, and connect hose to water tank



## SHURFLO FAUCET WATER TAP

**051291 UNBOXED**

**005958 RETAIL BOXED**

Plastic rotating faucet with built in 12V switch designed for use with a water pump or pressure reducing city water entry.

### FEATURES:

- Folds down and is ideal for slide out camper trailer kitchens
- White
- 3/8" hose connection



### CAMEC HIGH BASIN MIXER SQUARE

**041676**

#### FEATURES

- WELS rated, complies Australian/NZ standard AS/NZS 6400
- Stainless steel braided hoses 350mm length and 1/2" female BSP threads
- 35mm cartridge



### CAMEC 3 WAY SINK MIXER

**041677 CHROME**

**042791 35MM REPLACEMENT CARTRIDGE**

#### SPECIFICATIONS

- Top lever controls hot/cold water mixing
- Bottom lever controls separate filtered water line



### METAL FOLDING HOT/COLD WATER MIXER TAP SUIT UNDER GLASS SINK

**043526**

#### FEATURES

- Solid chrome on brass construction
- Hot/Cold mixer
- Fold down tap
- Low profile to suit the Dometic/Cramer sinks with fold down lid
- Supplied with flexible hoses. Hose input is 1/2 inch male BSP thread

#### SPECIFICATIONS

- Suits 40mm hole cut out
- Minimum height required above mounting base = 25mm
- 160mm spout from pivot point to end of spout
- 45mm in height from bench/sink top.
- Female 1/2 inch BSP thread on Hot & Cold connectors



### BRASS MAINS PRESSURE A FRAME TAP

**005975**

#### SPECIFICATIONS

- Vertical face mount brass tap
- Easily mount on A-frame and pipe into existing water supply line



### CAMEC 3 WAY SINK MIXER

**050954 BLACK**

3 way sink mixer incorporates two taps in one - a sink mixer and a filtration faucet. This dual stream has two outlets in the spout and eliminates the need to mount a second faucet for filtered water. Please Note: The tap does not filter water, a separate filtration kit is required.

#### FEATURES

- WELS rated, complies Australian/NZ standard
- AS/NZS 6400
- Stainless steel braided hoses 350mm length and 1/2" female BSP threads



### WHALE TELESCOPIC FAUCET

**005937**

Mainly used with foot pumps, the telescopic outlet swivels through 360 degrees and can be pushed down when not in use.

#### FEATURES

- Great space saver



### WHALE TUCKAWAY FAUCET

**005938 WITH ON/OFF SWITCH**

**005939 STANDARD**

This faucet fits onto the vertical side of the sink bowl and folds down neatly for storage within the sink. Simply drill a hole into the side of the sink and pass through the thread with rubber seal from the front.

- Rear screws on, providing a two stage hose barb to suit 3/8" or 1/2" hose



### HOT/COLD BASIN MIXER

**005993**

This faucet features hot and cold mixer taps, complete with high rise 200mm swivel spout to allow easy filling of jugs and kettles.

#### FEATURES

- Chrome on metal finish.
- Model: MG3100
- Supplied with 2 x hot/cold hoses with 3/8 male BSP



### SINGLE CHROME COLD TAP

**005995**

Low profile fixed pillar tap.

#### FEATURES

- Chrome on metal finish



### TAP DECK WASHDOWN SINK

**005996**

Single tap with threaded outlet, suit washing machine or where a hose is to be connected.

#### FEATURES

- Chrome on metal finish



### MIXER MI2000/1 MINI SGL LEVR

**006002**

The mixer will fit in a single hole in your bench top or wall. Comes with 3 flexible hoses (200mm long), that connect to the underside of the tap.

#### FEATURES

- Features solid handle.
- Tap is chrome finish on metal. Has non-drip ceramic discs.

#### SPECIFICATIONS

- All have 3/8 BSP male thread
- The thickness of mounting can be from 30mm to 0.5mm thick
- Width of top flange section 42mm
- Hole size required in sink or bench 32mm
- Hot water in, cold water hose in, mixed water hose out



### MIXER ART 33 SGL LEVER CHROME

**006004**

Shower set mixer, suit recessed shower set. This is a mixer only without spout - usually used with a shower hose/rose.

#### FEATURES

- The mixer will fit in a single hole in your bench top or wall. Comes with 3 flexible hoses (200mm long), that connect to the underside of the tap.

#### SPECIFICATIONS

- Mixed outlet is Male 3/8 inch BSP thread
- Hot inlet is Male 3/8 inch BSP thread
- Cold inlet is Male 3/8 inch BSP thread
- Suit bench thickness 1mm to 25mm
- Tap covers a hole up to 41mm as is, or if using the included large washer up to 49mm max.
- The mixer thread diameter measures 1 1/4 Inch which is slightly under 32mm. You will need some clearance.



### SINGLE FOLD DOWN TAP - R OR L OPTION

**005895 RIGHT HAND SIDE OF SINK**

**005904 LEFT HAND SIDE OF SINK**

Requires barb to take 12mm hose (005951)

#### SPECIFICATIONS

- 3/8" male BSP male fitting



### HOT/COLD BASIN MIXING FAUCET

**005910**

Hot and cold mixer set with fold down faucet.

#### SPECIFICATIONS

- Requires barb to take 12mm hose (005951 x 2)
- Chrome
- 3/8" male BSP male fittings

### BARWIG SINGLE FAUCET AND SWITCH

**005953 BARWIG SINGLE 052 FAUCET & SWITCH**

**005954 BARWIG SINGLE 052 FAUCET NO SWITCH**

#### SPECIFICATIONS

- Maximum Inlet Pressure: 35psi

### SINGLE FOLDING FAUCET CHROME

**005990**

Single folding faucet - when folded body is 39mm high.

#### FEATURES

- Chrome finish



**CARTRIDGE T/S L/H & R/H FAUCET**

**005896**

Replacement cartridge to suit fold down chrome taps (005895, 005904, 005910)



**CAMEC TAP HANDLE**

**005899**

Suits the fold down mains pressure taps. Includes various spline adapters, brass screw and colour buttons.



**BRASS UNION 1/2" BSP X 3/8" FEMALE WITH WASHER**

**005951**

Water, brass adaptor, female 3/8" BSP to 12.5mm barb. Clamp your 12mm hose to one end the other end screws onto a male 3/8" BSP thread.



**BLACK KITCHEN MIXER TAP**

**050950**



**BLACK KITCHEN MIXER TAP**

**050951**



**BLACK KITCHEN MIXER TAP**

**050952**



**BLACK PAPER HOLDER**

**050939**



**BLACK SHOWER MIXER**

**050937**



**BLACK SHOWER MIXER**

**050938**



**BLACK SHOWER RAIL**

**050947**



**BLACK TALL MIXER TAP**

**050936**



**DOUBLE ROBE HOOK**

**050940**





### RECESS TRANSOM SHOWER KIT

051129

Flush mounting aft deck swim shower kits includes -

#### SPECIFICATIONS

- White nylon container with hinged door and catch
- Quality chrome brass hot & cold water mixer tap
- Adjustable flow shower head
- 3 or 5 metre shower hose with chrome fittings
- Concealed fastening holes for a neat finish



### TRIGGER SHOWER SET

005857

This trigger shower set has a heavy duty chrome finish. On/off trigger incorporated in handle. Wall bracket to suit (refer code 005872).

- White



### WALL BRACKET

005872

Bracket to suit trigger and elbow shower set.

- Chrome



### HOT/COLD SHOWER MIXER ONLY CHROME WITH CRYSTAL HANDLES

005861

To suit hand held showers.

- Chrome
- 3/8 MBSP connections



### RECESS SHOWER HEAD/HOSE W ON/OFF

005856

Hose and rose pulls out externally from underneath cap



### SHOWER HOSE 1.5M

005870

Hose to suit elbow shower set (refer code 005869).

#### SPECIFICATIONS

- 1/2" female at handpiece end
- 3/8" male at mixer end



### ON/OFF TRIGGER SHOWER SET

043267

On/off trigger incorporated in handle. Chrome hose 1.5m.

- White/chrome



### SHOWER MIXER ONLY SOLID HANDLE

005862

- Chrome



### CAMEC SHOWER WALL MIXER

041678

Shower wall mixer 40mm cartridge.

#### FEATURES:

- WELS rated complies Australian/NZ standard
- AS/NZS 6400
- 405mm cartridge



### SHOWER WITH ADJUSTABLE FLOW RATE/HOSE ELBOW

005869

This elbow shower set comes complete with adjustable flow rate nozzle. Heavy duty construction.

#### FEATURES

- Heavy duty chrome finish
- Includes adjustable flow rate nozzle
- Wall bracket to suit - refer code 005872

#### SPECIFICATIONS

- Hose: 1.5m length
- Chrome hose
- White handle



### THROUGH BULKHEAD ELBOW CONNECTOR

005874

This fitting is used to connect hand shower sets where installation is required through wall fixing.

#### FEATURES

- Heavy duty chrome finish
- This elbow fits the CAMEC shower and trigger shower hose
- 3/8" BSP through wall and outlet suits chrome flexible shower hose, which is also 3/8" BSP
- Chrome



### CAMEC SHOWER KIT

**005860**

CAMEC Shower Kit, with mixer, rose, hose & bracket. Heavy duty construction.

#### FEATURES

- The shower hose connection on the mixer is a swivel type so the taps can be mounted on a vertical or horizontal surface.

#### SPECIFICATIONS

- Hand held shower rose.
- Adjusting nozzle.
- An adjustable swivel wall bracket to hold shower rose.
- Chrome covered shower hose.
- Hot & cold chrome mixer tap.



### SHOWER BOX WITH HOT COLD MIXER PULL OUT PUSH BUTTON

**005822**

A compact shower with a long hose.

#### SPECIFICATIONS

- Dimensions: 180mm(l) x 130mm(h) x 325mm(d)
- 4m hose
- White



### SINGLE ROBE HOOK

**050941**



### BREHA 9100 SHOWER HOSE WHITE

**005885**



### RECESS EXTERNAL WALL SHOWER

**005810 SHOWER KIT WHITE**

**005832 REPLACEMENT HOSE WHITE**

**042898 SHOWER KIT BLACK**

**044458 RECESSED WALL SHOWER KEY**

Suitable for external recessed wall types, annexes, shower tents, etc. with keyed lock security.

#### FEATURES

- Fade and impact resistant, UV stabilised and can be painted
- Unit screws into the cut-out from the outside face - screws are covered when door is closed
- Hot and cold pipes connect at the rear to 1/2" BSP male water pipe fitting. Same goes for the shower rose connections
- On/off switch on shower rose
- Shower rose can be either hand held or bracketed to door

#### SPECIFICATIONS

- Cut-Out Size: 155mm x 280mm (w)
- Can be installed either horizontally or vertically
- Extends outside just 12-15mm
- 120mm from mounting inside to end of threads



### SHOWER SET WITH SLIDING BAR

**005882**

Includes double lock flexible hose and soap holder.

#### SPECIFICATIONS

- Sliding Bar - 690mm length
- Brass double lock
- Flexible hose



### SINGLE TOWEL RAIL

**050943**



### HANDHELD SHOWER ROSE AND BRACKET WHITE

**005833**

# FILTRATION



## B.E.S.T. INLINE WATER FILTER

**038332 322H WITH HOSE CONNECTORS**

**043282 1/2" FBSP NO FITTINGS 322T**

**044190 NLON BUSH - 3/4" M TO 1/2" BSP FEM**

The hose range is a DIY installation - it connects to your drinking water/filling hose in less than a minute. This inline is dual purpose - it can be used on your hose to fill your tanks and also when you are connected directly to mains water.

### FEATURES

- Reversible - if the flow reduces, simply reverse the unit, hook it back up and flush the dirt away
- Compact - stores away with your hose
- Sealed - no cartridges
- Replace after approx 5,000 LT



## B.E.S.T. INLINE MOUNTING CLIPS

**038333**

Mounting clips for B.E.S.T. Inline Water Filter (refer code 038332).

### SPECIFICATIONS

- Pack of 2



## THIRSTY NOMAD WATER EXT

**051538**

For the first time in Australia, The Thirsty Nomad brings affordable water purification to the RV sector. Based scientific evidence and the latest in water purification technologies to Australian caravanners, requiring no power and no chemicals.

### FEATURES

- 5 Stage water treatment system to purify water
- Removes 10 heavy metals inc. Lead, Fluoride, Arsenic III and Arsenic V
- A Grade NSF Certified, 5 micron Carbon Fibre Block (CFB)
- CFB has up to 20 X higher contaminant removal than granular carbon
- Long lasting at 7,500 litres (pending water quality)
- 99.9% of bacteria blocked from bacterial colonisation of carbon
- 0.01micron Ultrafiltration
- Quantum Disinfection™ kills 99.9999% of bacteria & viruses upon contact
- Meets Australian Drinking Water Guidelines for E-Coli



## SHURFLO FILTRATION KIT FOR RV AND MARINE

**036794 KIT**

**036795 FILTER CARTRIDGE REPLACEMENT**

Designed for both RV and marine applications.

### FEATURES

- Supplied complete with all parts and fittings including carbon block disposable filter
- Reduces unpleasant tastes and odours
- Provides fresh, clean drinking water



## THIRSTY NOMAD WATER EXT

**051539**

For the first time in Australia, The Thirsty Nomad brings affordable water purification to the RV sector.

Based scientific evidence and the latest in water purification technologies to Australian caravanners, requiring no power and no chemicals.

### FEATURES

- 5 Stage water treatment system to purify water
- Removes 10 heavy metals inc. Lead, Fluoride, Arsenic III and Arsenic V
- A Grade NSF Certified, 5 micron Carbon Fibre Block (CFB)
- CFB has up to 20 X higher contaminant removal than granular carbon
- Long lasting at 7,500 litres (pending water quality)
- 99.9% of bacteria blocked from bacterial colonisation of carbon
- 0.01micron Ultrafiltration
- Quantum Disinfection™ kills 99.9999% of bacteria & viruses upon contact
- Meets Australian Drinking Water Guidelines for E-Coli



## AQUATAB WATER TABLETS 50-BOX

**000263**

Effervescent water purification tablets. When dissolved in one litre of water, renders water suitable for drinking after just thirty minutes.

### FEATURES

- Fast acting and fast dissolving

### SPECIFICATIONS

- Pack of 50
- 1 tablet/1 litre water



## CLEANOXIDE WATER TREATMENT

**043283**

### FEATURES

- Controls bacteria, fungi, viruses, biofilm and algae
- Neutralises unpleasant taste and odours from the tank
- Effective over a wide pH range (4 to 10)
- Biodegrades in sunlight, so no harmful effects on the environment if flushing your tank
- Active ingredient was approved in Australia for the treatment of drinking water in 2005
- Each tablet treats 100 to 400 litres of water
- Zip-lock pouch with full instructions on the back
- Contains 8 x 4g tablets



## WHALE AQUA SOURCE WATER FILTER

**026528**

An inline water filter to be fitted in the cold water pipe.

### FEATURES

- Very efficient
- When fitted, filter will remove foreign bodies and dirt particles, nasty tastes and smells
- Disposable
- 4,500LT lifespan

# GAS COMPLIANCE & SAFETY



## GAS DETECTOR 12V MTG 3000H

043896

The MTG-3000H Gas Alarm is intended to detect leakage of bottled gas. It is intended for installation in caravans and boats. The alarm is connected to a power source of 12V DC (non polarised) when used in caravans or boats, or connected to the mains through an external transformer (Not included) 240V AC/12V DC

### FEATURES

- While a 240v-12v transformer is provided, it does not have an Australian plug - you will need to remove the transformer plug to wire into your 12V system.
- Connecting to your 12v system will provide power.

### SPECIFICATIONS

- Measures a small 75 x 75 x 35mm



## LP GAS STORAGE STICKER

042544

Red and White LP Gas Storage Sticker

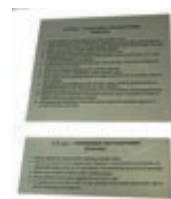

## LPG CONSUMER INSTRUCTION PLATE (CARAVAN)

003869

Metal gas instruction plate with consumer instructions for fixing to caravans

### SPECIFICATIONS

- Dimensions: 100mm(l) x 100mm(h) x 1mm(d) large plate
- Pack of 2 different pieces
- Small plate 100 x 45 x 1mm



## DECAL GAS VENTILATION

043380

White with black writing.

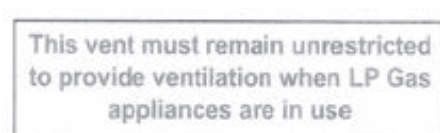

## DECAL GAS VENT UNRESTRICTED

043381

White with black writing.



## GAS PRESSURE TEST POINT 5/16" FLARE

003909

This test point is located immediately downstream from the regulator. It allows the user to easily test that gas is coming through the regulator and that it is at reduced pressure.

### SPECIFICATIONS

- 5/16" SAE Male x 3/8" BSPT Male
- Inlet: 3/8" - screws into regulator
- Outlet: 5/16" SAE Male flare



## GAS DETECTOR SAFE-T-ALERT 12V

000342

Gas detector Safe-T-Alert 12V suitable for LPG and natural gas.

### FEATURES

- Draws 46 MA and is simple to operate
- When the test switch is activated a complete diagnostic test is performed
- The detector is fully operational from 6 to 16V DC, providing continuous operation
- Required 12V permanent connection



## GAS COMPLIANCE DECAL

003875 NO:3 - NEAR STOVE

003877 NO:5 - BOOT LID

003878 NO:6 - EVACUATION

Consumer instructions for fixing to caravans/marine craft.



## GAS TEST POINT 3/8" FLARE

003910

This test point is located immediately downstream from the regulator. It allows the user to easily test that gas is coming through the regulator and that it is at reduced pressure.

### SPECIFICATIONS

- 3/8" SAE Male x 3/8" BSPT Male
- Inlet: 3/8" - screws into regulator
- Outlet: 3/8" SAE Male flare

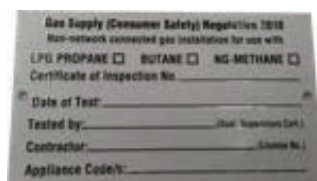

## LP GAS COMPLIANCE PLATE NSW

003871 95MM X 55MM

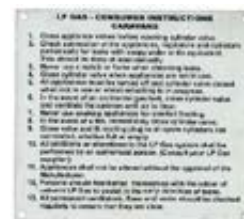

## LPG INSTRUCTION PLATE

051498

# GAS COPPER PIPE & FASTENERS



## COPPER TUBE

003950 1/4" 30M ROLL  
003952 5/16" 30M ROLL  
003954 3/8" 18M ROLL

Annealed copper tube suitable for gas installations.



## SADDLE

003959 SADDLE COPPER 5/16" - 7.95MM TUBE  
003960 SADDLE COPPER 3/8" - 9.52MM TUBE  
003961 SADDLE COPPER 1/2" - 12.7MM TUBE  
PLASTIC  
042642 13MM SADDLE CLAMP  
042656 19MM SADDLE CLAMP



## YELLOW THREAD SEAL GAS TAPE

004063

Used on threaded joins on gas pipe.

- Yellow
- 12mm
- 10m

# GAS FITTINGS & ADAPTORS



## ADAPTOR 3/8LH F-TO 1/4BSP MALE

051461



## ADAPTOR 3/8LH MALE TO 1/4BSP F

051462



## ADAPTOR 9KG BOT-TO 3/8LH COMP

051464



## ADAPTOR MALE POL TO 1/4 BSP M

051463



## GF5 ADAPTOR GAS FITTING

050044

GF5 adaptor gas fitting adaptor 1/4 BSPF x 3/8 male SAE for BBQ and ring burners.



## GF12 ADAPTOR GAS FITTING QUICK CONNECT

050045

Quick action connect 3/8 SAEF x 3/8 SAEM QC80





#### N06 FLARE NUT SAE

003967 N06 FLARE NUT 5/16 SAE FEMALE  
 003968 N06 FLARE NUT 3/8 SAE FEMALE  
 003973 N06R RED FLARE NUT 3/8 X 5/16 TUBE  
 003974 N06R RED FLARE NUT 1/2 X 3/8 TUBE



#### N07 UNION SAE TO BSP

003976 1/4 X 3/8 MALE SAE & MALE BSP  
 003977 5/16 X 1/8 MALE SAE & MALE BSP  
 003978 5/16 X 1/4 MALE SAE & MALE BSP  
 003979 5/16 X 3/8 MALE SAE & MALE BSP  
 003980 5/16 X 1/2 MALE SAE & MALE BSP  
 003981 3/8 X 1/8 MALE SAE & MALE BSP  
 003982 3/8 X 1/4 MALE SAE & MALE BSP  
 003983 3/8 X 3/8 MALE SAE & MALE BSP  
 003984 3/8 X 1/2 MALE SAE & MALE BSP



#### N08 ELBOW

003989 5/16 MALE SAE X 1/4 MALE BSP  
 003990 5/16 MALE SAE X 3/8 MALE BSP  
 003992 3/8 MALE SAE X 1/4 MALE BSP



#### N016 FEMALE UNION

003995 1/4 MALE SAE X 1/4 FEMALE BSP  
 003997 5/16 MALE SAE X 1/4 FEMALE BSP  
 003998 5/16 MALE SAE X 3/8 FEMALE BSP  
 004000 3/8 MALE SAE X 1/4 FEMALE BSP  
 004001 3/8 MALE SAE X 3/8 FEMALE BSP  
 004002 3/8 MALE SAE X 1/2 FEMALE BSP  
 004003 1/2 MALE SAE X 3/8 FEMALE BSP



#### N017 DOUBLE UNION

004004 1/4 MALE SAE X 1/4 MALE SAE  
 004005 5/16 MALE SAE X 5/16 MALE SAE  
 004006 3/8 MALE SAE X 3/8 MALE SAE  
 004007 5/16 MALE SAE X 1/4 MALE SAE  
 004008 3/8 MALE SAE X 5/16 MALE SAE



#### N018 DOUBLE ELBOW

004010 5/16 MALE SAE X 5/16 MALE SAE  
 004011 3/8 MALE SAE X 3/8 MALE SAE



#### N019 3-WAY TEE

004013 5/16 SAE  
 004014 3/8 SAE



#### N024 REDUCING BUSH

036529 3/8 MALE BSP X 1/4 FEMALE BSP  
 036530 1/2 MALE BSP X 1/4 FEMALE BSP  
 036531 1/2 MALE BSP X 3/8 FEMALE BSP



#### N025 EXTRUDED ELBOW

004018 1/4 MALE BSP X 1/4 FEMALE BSP  
 036532 3/8 MALE BSP X 3/8 FEMALE BSP



**N027 HEXAGON NIPPLE 1/4" X 1/4"**

004020 1/4" MALE BSP X 1/4" MALE BSP

**N036 FEM UNION ELBOW**

004028 3/8 MALE SAE X 3/8 FEMALE BSP

**N038 SINGLE UNION BODY**

036542 5/16 MALE BSP X 1/8 MALE BSP

036543 5/16 MALE BSP X 1/4 MALE BSP

036544 5/16 MALE BSP X 3/8 MALE BSP

**N038 SINGLE UNION BODY**

036546 5/16" MALE BSP X 3/8" FEMALE BSP

**N039 DOUBLE UNION BODY**

036547 5/16" X 5/16"

**N056 FLARE CAP NUT**

004029 5/16" FEMALE FLARE SAE

004030 3/8" FEMALE FLARE SAE

**N062 - 1/4" MALE BSP X 1/4" FEMALE  
INVERTED FLARE UNION**

004033

Used to convert copper pigtailed with dual/changeover regulators. For use with single OPP regulators less POL.

**SPECIFICATIONS**

- Female Union 1/4" Male BSPT Inverted Flare 1/4"

**N065 FLARE PLUG**

004035 5/16" MALE FLARE SAE

004036 3/8" MALE FLARE SAE

**N070 FLARE SWIVEL CONNECT**

004037 5/16" FEMALE SAE X 5/16" FEMALE SAE

004038 3/8" FEMALE SAE X 3/8" FEMALE SAE

**N072 ADAPTOR**

036553 3/8" FEMALE BSP X 1/4" MALE BSP

036554 1/2" FEMALE BSP X 1/4" MALE BSP

036555 1/2" FEMALE BSP X 3/8" MALE BSP



### N073 REDUCING NIPPLE

036556 1/4" MALE BSP X 1/8" MALE BSP  
004041 3/8" MALE BSP X 1/4" MALE BSP



### BALL VALVE

004043 1/4FBSP X 1/4FBSP  
004046 5/16 SAE & NUTS  
004047 3/8 BSP & NUTS  
004048 3/8 SAE NO NUTS



### FEMALE 3/8" LEFT HAND THREAD X FEMALE POL

004054 ATTACH TO 3/8" L/H CYLINDER TO TAKE P.O.L  
FITTINGS  
004059 ELBOW FEMALE 3/8" LH TO FEMALE P.O.L



### ELBOW 3/8" LEFT HAND THREAD

004056 3/8" MBSP X POL MALE LH R ANGLE

Attaches to P.O.L (9kg) type cylinder to take 3/8" L/H fittings.



### GAS ADAPTOR 1/2" MALE BSP X 5/16" SAE MALE FLARE

042580

Commonly used to attach 5/16" copper pipe to gas bayonet (004051)



### GAS BAYONET FLOOR MOUNT CHROME 1/2" FEMALE BSP

004051

To suit low pressure appliances such as barbeques and flueless space heaters. For floor or wall mount.

#### FEATURES

- Chrome plated
- Dust cap
- Mounting screws x 2

#### SPECIFICATIONS

- Connection: 1/2" female
- Maximum Inlet Pressure: 7kPa
- Chrome



### MALE BAYONET FITTING

033800

Low pressure appliance hose adaptor.

#### FEATURES

- Brass
- Bayonet to 1/4" male BSP



### GAS BAYONET DUST CAP

043382

Keeps your gas bayonet socket clean and free of dirt and insects.



### O RING ADAPTOR GAS FITTING

050347

Replacement O-ring for P.O.L fittings.

# GAS CYLINDERS & PRODUCTS



## GAS CYLINDERS

003856 1.25KG 3/8 L/H THREAD

003857 2KG 3/8 L/H THREAD

051294 GAS CYL 4KG C/W POL-SQUAT LCC27 VALVE

051570 GAS CYL 4.5KG C/W POL-TALL TYPE 27 VALVE

051569 GAS CYL 9KG POL NO GAUGE CAMEC TYPE 27 VALVE

## SPECIFICATIONS

- Diameter 260mm
  - Overall Height 348mm
  - Water Capacity 9.6Kg
  - Tare Weight 5.5Kg (approx.)
  - Finish Powder coated (Class 2)
  - Test Pressure 3.3MPa
  - Valve SCG POL with sullage
- Valve outlet POL 0.885" -14NGO-LH-INT (CGA510)



## CYLINDER FRONT OPENING CRADLE

050030 SMALL SUIT 4KG CYLINDERS

050031 LARGE SUIT 9KG CYLINDERS

Brackets included to enable welding



## GAS CYLINDER CRADLE, EXTRA STRONG BASE

003829 9KG WITH ADJUSTABLE CLASP

039073 4KG WITH ADJUSTABLE CLASP

Brackets included to enable welding

# GAS HOSES



## BAYONET HOSE 3/8" SAE FEMALE X MALE BAYONET

051257 1500MM

051258 3000MM

### SPECIFICATIONS

- Class A low pressure appliance
- Suit Weber Q BBQ
- This has a SAE female thread



## BARFLEX HOSE 3/8" BSP FF X MALE BAYONET

035693 1M

035694 2M

### SPECIFICATIONS

- Commonly used on gas room meters
- Class A low pressure appliance
- NB: this has a BSP female thread



## GAS HOSE 1200 BRAID X 5/16" MALE 003932

### SPECIFICATIONS

- Class C high pressure appliance
- Maximum Working Pressure: 2600kPa
- Working Temperature Range: -20°C to +65°C
- 5/16" male SAE fittings at each end



## GAS BAYONET HOSE

002913 2.0M BAYONET X 1/4" BSPF

002914 1.5M BAYONET X 1/4" BSPF

002920 1.2M BAYONET X 1/4" BSPF

### SPECIFICATIONS

- Class B low pressure/high temperature appliance
- Maximum Working Pressure: 14 kPa
- Working Temperature Range: -20°C to +125°C



## GAS HOSE STAINLESS STEEL SUIT DOUBLE CYLINDER WITH HAND WHEEL

003902

### SPECIFICATIONS

- 450mm x 7/16" inverted flare with hand wheel
- Class C
- Maximum Working Pressure: 2600kPa
- Working Temperature Range: -20°C to +65°C
- Used to attach cylinder to changeover manifold (043464)
- With hand wheel for hand tight fitting
- Suits twin cylinder



## PIGTAIL - TYPE 27 - CLASS F

051792 6MM S/S PIGTAIL LCC27 CLASS F 7/16 -24 I/F 450MM

051793 6MM S/S PIGTAIL LCC27 CLASS F 7/16 -24 I/F 600MM

051794 6MM S/S PIGTAIL LCC27 CLASS F 1/4" NPT M 450MM

051795 6MM S/S PIGTAIL LCC27 CLASS F 1/4" NPT M 600MM



## PIGTAIL COPPER POL TO CHANGEOVER REGULATOR

003897 762MM (30")

036517 460MM (18")

### SPECIFICATIONS

- Not suitable for single cylinder installations
- POL x 7/16" inverted flare suits most applications
- Class C
- Maximum Working Pressure: 2600kPa
- Used to attach cylinder to a change over regulator
- Suits twin cylinder setup

## GAS HOSE PVC

003944 600MM 1/4" F INV FLARE BSP X 1/4" F INV FLARE BSP

036508 2400MM 1/4" F INV FLARE BSP X 1/4" F INV FLARE BSP

036509 1800MM 1/4" F INV FLARE BSP X 1/4" F INV FLARE BSP

036510 900MM 3/8" MALE BSP X 1/4" F BSP INV FLARE

036512 300MM 1/4" F INV FLARE BSP X 1/4" F INV FLARE BSP

003919 1800MM 3/8" MALE BSP X 3/8" F FLARE SAE

003920 600MM 3/8" F FLARE SAE X 3/8" F FLARE SAE

003924 1200MM 3/8" F FLARE SAE X 3/8" F FLARE SAE

003935 1200MM 3/8" MALE BSP X 1/4" F BSP INV FLARE

003911 300MM 3/8" MALE FLARE SAE X 3/8" MALE BSP

003912 450MM 3/8" MALE FLARE SAE X 3/8" MALE BSP

003913 600MM 3/8" MALE FLARE SAE X 3/8" MALE BSP

003927 300MM 5/16" MALE FLARE SAE X 3/8" MALE BSP

003928 450MM 5/16" MALE FLARE SAE X 3/8" MALE BSP

003929 600MM 5/16" MALE FLARE SAE X 3/8" MALE BSP

003930 600MM 5/16" F FLARE SAE X 5/16" F FLARE SAE

003931 1200MM 5/16" F FLARE SAE X 5/16" F FLARE SAE

003937 1500MM 3/8" MALE BSP X 1/4" F BSP INV FLARE

044957 90MM 3/8" MALE BSP X 5/16" F FLARE SAE

### SPECIFICATIONS

- Class C high pressure appliance
- For use with LPG (propane)
- 6mm hose diameter



# GAS REGULATORS

A fixed regulator should always be installed in an upright position and the outlet of the regulator to be located higher than the valve on the cylinder.



## AUTO CHANGEOVER REGULATOR

050557

### SPECIFICATIONS

- Inlet Pressure: 100psi
- Two stage automatic changeover regulator complete with copper pig tails, mounting bracket and screws
- Automatically changes from one empty tank to another full tank for a limited time to allow lever to be manually pointed to the full cylinder



## MARSHALL SINGLE REGULATOR

042050 190MJ 195,000 BTU/HR

042051 290MJ GREEN TOP 285,00 BTU/HR

This two stage regulator combines both a high pressure first stage and a low pressure second stage regulator into a single unit. Ideal for RV applications to ensure a smooth and continuous flow.

### SPECIFICATIONS

- Inlet Pressure: 100psi
- Outlet Pressure: 11" W.C
- Inlet: 1/4" NPT FEM



## BRACKET - MARSHALL SGL REG/OPP

003886

Bracket Suit Marshall Single O.P.P.Reg. Metal bracket around 100mm long



## GAS REGULATOR SINGLE-STRAIGHT POL

036523 SPARE SOFT NOSE CONE

Straight adjustable soft nose regulator. Not for RV use

### SPECIFICATIONS

- Capacity: 175mj/hr - 3.5kg/hr
- Inlet: POL
- Outlet: 3/8" NPT



## SINGLE REGULATOR WITH OVER PRESSURE PROTECTION NO POL

036520

Non adjustable regulator for RV installations only.

### FEATURES

- Includes 1/4" inverted flare adaptor, bracket and fixing screws

### SPECIFICATIONS

- Capacity: 160mj/hr - 3.2kg/hr
- Inlet: 1/4" NPT
- Outlet: 3/8" NPT



## GAS REGULATOR OPP MANUAL DUAL AND BRACKET

003892

Non adjustable regulator for RV installations only.

### FEATURES

- Dual stage
- Complete with bracket and fixing screws

### SPECIFICATIONS

- Manual changeover
- Capacity: 160mj/hr - 3.2kg/hr
- Inlet: 7/16" FNPT x2
- Outlet: 3/8" NPT



## CARAVAN, MOTORHOME 2 STAGE GAS REGULATOR AND BRACKET

051644

Dual Stage Gas Regulator, complete with mounting bracket and fixing screws.

Adjustable Regulator for Caravan's, Campervan's, Motorhome's & RV Installations Only.

### SPECIFICATIONS

- Flow Rate: 280 Mj/hr
- Pressure: Inlet 1750 kpa Outlet 2.75 kpa
- For added safety there is a built in pressure relief device, which is set to 4.2 KPA
- 1/4" BSP Female Inlet.
- 3/8" BSP Female Outlet.
- Adjustment range 9 - 13" WC
- Length: 144mm
- Width: 84mm
- Height: 76mm
- Easily switch between cylinders. Replacement manifold for twin cylinder regulator set ups.



## MANUAL CHANGEOVER GAS VALVE

043464

Easily switch between cylinders. Replacement manifold for twin cylinder regulator set ups.